

R-13

**CERTIFIED RECORD OF LAND CORNER MONUMENTATION**

**History of original corner establishment:**

Original survey by J. Currin Et Al under special contract 1887:

- Set a Post 4 ft. long, 4 ins. square 24 ins. in the ground for corner to Sec's 21, 22, 27, and 28, marked:
  - T1N S22 on NE
  - R35E S27 on SE
  - S28 on SW and
  - S21 on NW Faces

- With 2 notches on S and 3 notches on E edges, from which
  - A Pine 16 ins. diam. bears N 70°E 49 lks. dist. marked T1N S22 BT.
  - A Pine 24 ins. diam. bears S 35°E, 72 lks. dist. marked R35E S27 BT.
  - A Pine 18 ins. diam. bears S45°W 58 lks. dist. marked T1N R35E S28 BT.

No other trees in limits. I raise mound of stone alongisde. (Continued on Page 2)

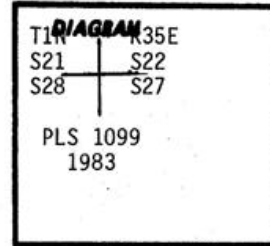

R-13

**Description of corner evidence found:**

At the corner point, we find a 3/4" iron pipe extending 24" above ground in a mound of stone approx. 2 ft. dia. and 1 ft. high, From which: The remains of the original bearing trees:

- A standing 26" Ponderosa Pine snag with scribing "T1N S22" visible on an open blaze bears N 64°E 33.4 ft. (32.3 ft. to face). It appears that the open blaze is the original, however the scribing appears to be recently made or touched up. We open the lower blaze near ground level and find good scribing "BT"
- A sawn Ponderosa Pine stump 24" dia. bears S 24°E 48.3 ft. (47.5 to face) with unhealed and burnt single blaze, no scribing visible. The tree portion from this stump is lying alongside with scribing "R35E S27" visible on an open blaze.
- A sawn Ponderosa Pine stump, 20" dia., bears S 57° W 33.0 ft., the tree portion is gone. We open and find good scribing "BT" on a single blaze near ground level. Bearing trees marked recently: (Continued on Page 2)

**Description of monument and accessories I established to perpetuate the original location of this corner:**

At the corner point and in place of the found 3/4" iron pipe, we set a 2"x30" galvanized iron pipe, 20" in the ground to bedrock and rebuild mound of stone around 2" iron pipe 3 ft. dia. and 1 ft. high, with brass cap attached, marked: T1N R35E S21 S22 S28 S27 We reset 3/4" iron pipe alongside of brass cap and mark the following new bearing trees:

- A 12" Douglas Fir, scribed "T1N R35E S22 BT" on a double blaze bears N 31°E 44.7 ft. PLS 1099 1983
- A 12" Ponderosa Pine, scribed "T1N R35E S28 BT" on a double blaze bears S 83°W 73.7 ft.
- A 6" Ponderosa Pine, scribed "T1N R35E S27 BT" on a double blaze bears S25 1/2° E 30.4 ft.
- And a 12" Ponderosa Pine, scribed "T1N R35E S21 BT" on a double blaze bears N 59 1/2°W 56.7 ft.

Attached brass washer marked "LS 1099" to lower blaze of new BT's. Bearing and Horizontal Distance measured to center of bearing trees at ground level.

Staff Compass (19 1/2° East Declination) Steel Tape  
October 5, 1983 Witnesses: Gary Langlitz LS 1099  
Dick Humiston

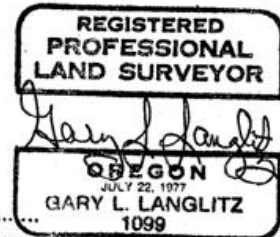

Office of Surveyor County of Wasilla  
 State of Oregon I hereby certify that the within instrument was filed in this office  
 for record on the 11th day of November, 1983  
David Humiston by Dalby Cochran  
 (COUNTY OFFICIAL) (DEPUTY)

History of original corner establishment: (Continued from Page 1)

Remonumentation by unknown parties. I consulted with the Umatilla County Surveyor's Office who's records indicate that work was performed at this corner, but the specific record is not available.

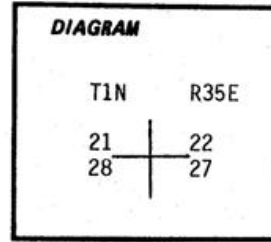

Description of corner evidence found: (Continued from Page 1)

A 16" Douglas Fir, in good condition with scribing "S27 T1N R35" visible on a partially healed single blaze bears S87 1/2°E 4.4 ft. And a 10" standing Lodge Pole Pine snag with scribing "S21 T1N R35 BT" visible on an unhealed single blaze bears N 12°W 14.4 ft.

We are unable to find a location where more than two dimensions given in the original notes can be utilized. Individual points established at record measurement from each original BT are spread over an area approx. 16 ft. N-S and 6 ft. E-W. An average of the position falls approx. 3 ft. from the found 3/4" iron pipe. We decide to accept the position of the 3/4" iron pipe since it is near the average position dictated by the original evidence and it is generally faced by all three original blazes.

Description of monument and accessories I established to perpetuate the original location of this corner:

Office of..... County of.....  
 State of....., I hereby certify that the within instrument was filed in this office  
 for record on the..... day of....., 19.....  
 (COUNTY OFFICIAL) by (DEPUTY)