

**OREGON CORNER RESTORATION FORM**

Section 35 Township 1N Range 32E  
 County Umatilla Date: July 1, 2009

Corner Designation: 1N32Z21  Condition Report Only  
 Not found  
 Remonumented  
 Unrecorded  
 Surveyed in  
 Referenced out

South section corner to Sections 35 and 36 T1N, R32E  
 W.M., Umatilla County.

Previous Renewals / Surveys, etc.

Corner originally set by David P. Thompson under contract No. 79, dated July 26, 1858. His record reads: Set stone 38x8x8 ins for corner to secs. 35 and 36. James Currin and James Noland, under special instructions dated May 4, 1887 say: Set basalt stone or boulder 16x12x6 ins. for cor. to secs. 35 and 36. Lincoln Wilkes in the survey of the Diminished Indian Reservation in 1917 found a basalt stone 10x4x4 ins. Don Staebler in survey 92-42-B set a brass cap. His record states: Found an 18"x14"x6" stone with a cross on top, 5 notches on the west side and 1 notch on the east side.

Monument and Accessories found: ( condition and source )  
 I found the brass cap as described by Staebler in good condition.

**DIAGRAM**

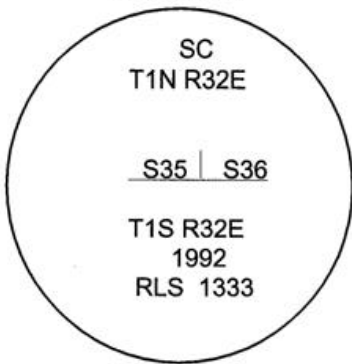

**SKETCH**

MONUMENT (S) AND ACCESSORIES SET (Procedures and Description)  
 None.

This monument was tied to report the Oregon State Plane, NAD 83/1991 coordinates only.

Measurements were made with a Trimble R7/R8 RTK GPS system.

Location and comments  
 NAD 83/1991 State Plane Coordinate  
 Oregon North Zone  
 N = 678,660.65 ift  
 E = 8,646,452.65 ift

Compass Declination

Surveyors Seal

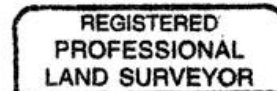

*Stephen K. Haddock*

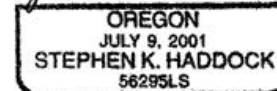

RENEWAL DATE 6-30-11

RECEIVED BY:  
Umatilla County Surveyor  
 Date: 6-10  
 Rec'd By: KK  
 No. 10-98-C

Firm / Agency  
 Witness Tree Surveying  
 Address  
 P.O. Box G  
 Pilot Rock, OR 97868  
 Party Chief  
 Stephen K, Haddock