

**OREGON CORNER RESTORATION FORM**

Section 12 Township 1N Range 32E  
 County Umatilla Date: July 13, 2009

Corner Designation: 1N32G25

Condition Report Only  
 Not found

East quarter corner of section 12 only, T1N, R32E,  
 W.M., Umatilla County, Oregon

Remonumented  
 Unrecorded  
 Surveyed in  
 Referenced out

Previous Renewals / Surveys, etc.

Corner originally set by David P. Thompson under contract No. 106 Dated August 16, 1864. His record reads: Set 1/4 sec. corner in mound of earth with charred stake, pits and trench. Zenas Moody, under contract No. 164 dated September 21, 1871 states: Set post and made earth mound. James Currin and James Noland under special contract dated May 4, 1887 state: Found pits and mound. Set a basalt stone 14x12x12 ins. marked 1/4 on west face and raised earth mound along side. Lincoln Wilkes in his 1917 resurvey states: Set an iron post, 3 ft. long, 2 ins. diam. for witness cor. to the 1/4 cor. of sec. 12, with brass cap.

Monument and Accessories found: ( condition and source )  
 None. This point falls in the middle of the county road.

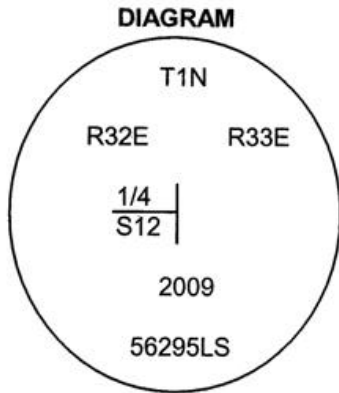

SKETCH

- = Brass Cap
- = Wilkes Monument (disturbed)
- = Rebar References

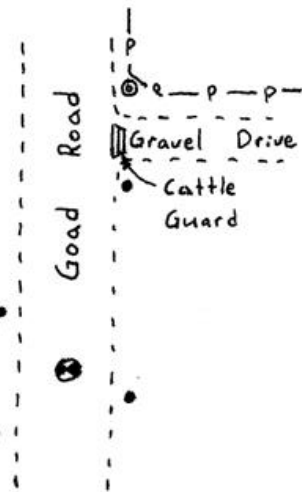

**MONUMENT (S) AND ACCESSORIES SET (Procedures and Description)**

At the proportionate point I set a 1 1/2" x 30" galvanized iron pipe with a 2 1/2" brass cap stamped as shown in the diagram above. The cap is 6" below the surface of the road.

For references I set four 5/8"x24" iron rebars with 1 1/4" orange plastic caps attached stamped WTS and 56295LS as follows:

- an iron rebar bears N57°25'07"W 26.73 feet at the corner of the existing fence.
- an iron rebar bears S21°52'17"W 61.90 feet near a railroad tie gate post.
- an iron rebar bears S22°10'52"E 36.13 feet 12 inches below the surface.
- an iron rebar bears N13°26'05"E 119.67 feet;

The Lincoln Wilkes brass cap for the closing 1/4 corner to Section 7, T1N, R33E, disturbed and protruding 18" bears N09°09'47"E 163.03 feet;

The monument was set and references were tied using a Trimble R7/R8 RTK GPS system.

Location and comments  
 NAD 83/1991 State Plane Coordinate  
 Oregon North Zone  
 N=702,509.55 ift  
 E=8,651,248.64 ift

Compass Declination

Surveyors Seal

RECEIVED BY:  
Umatilla County Surveyor  
 Date: 6-10  
 Rec'd By: KK  
 No. 10-93-C

Witness Tree Surveying  
 Address  
 P.O. Box G  
 Pilot Rock, Or. 97868  
 Party Chief  
 Stephen K, Haddock

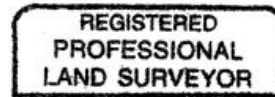

*Stephen K. Haddock*  
 OREGON  
 JULY 9, 2001  
 STEPHEN K. HADDOCK  
 56295LS

RENEWAL DATE 6-30-11