

**OREGON CORNER RESTORATION FORM**

Section 35 Township 1N Range 31E  
 County Umatilla Date: August 29, 2001

Corner Designation: 1N31Z17

South section corner to sections 34 and 35, T1N, R31E, W.M., Umatilla County, Oregon.

Condition Report Only  
 Not found  
 Remonumented  
 Unrecorded  
 Surveyed in  
 Referenced out

Previous Renewals / Surveys, etc.

The corner was originally set by Josiah Burnett under contract No. 92 dated September 12, 1860. His record reads: Set post for corner to secs. 34 & 35 drove charred stake & raised mound with trench as per instructions. The County surveyor, Aubrey Perry, records a "Rock Cor. to Sec. 34-35 in his survey recorded in Book 2, Page 301 of the Record of Private Surveys dated March 1919.

Monument and Accessories found: ( condition and source )

A fence corner with fences running North, West and Southwest with many stones scattered about. The fence corner location agrees with the call for distance from the Perry survey.

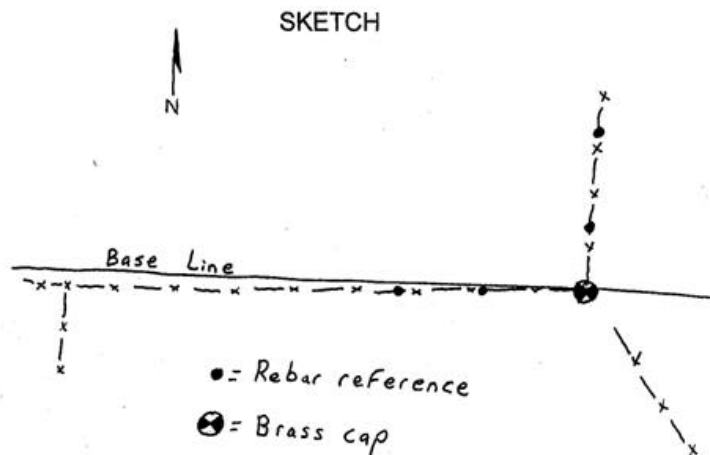
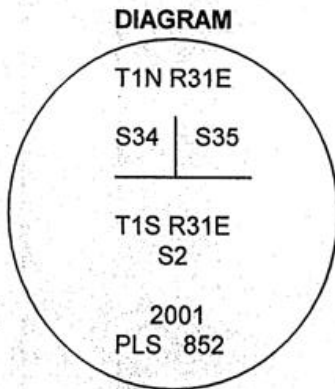

**MONUMENT (S) AND ACCESSORIES SET (Procedures and Description)**

At the fence corner I set a 30" x 1 1/2" G.I.P. with a 2 1/2" brass cap stamped as shown in the diagram above 28" in the ground. I nailed a County monument sign on the fence.

For references, I set four 5/8" by 24" rebars with 1 1/4" red plastic caps stamped ORLS 852, and WALS 13922 as described below:

- an iron rebar bears N1°21'02"E, 42.98 feet, under the existing fence;
- an iron rebar bears N0°46'00"E, 74.92 feet, under the existing fence;
- an iron rebar bears N88°20'00"W, 38.33 feet, under the existing fence;
- an iron rebar bears N87°35'48"W, 57.84 feet, under the existing fence;

The monument and references were tied using a LIECA SYSTEM 300 RTK GPS.

Location and comments  
 OR SPC Oregon North 1983-91  
 N = 678039.91  
 E = 8608949.62

Compass Declination

Surveyors Seal

RECEIVED BY:  
Umatilla County Surveyor  
 Date: 12/30/2001  
 Rec'd By: DHK  
 No. 01-206-C

Firm / Agency  
 Haddock Surveying  
 Address  
 P.O. Box 1574  
 Pendleton, Or. 97801  
 Party Chief  
 Stephen K, Haddock

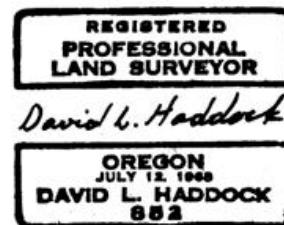

RENEWS 6-30-03