

OREGON CORNER RESTORATION FORM

Section 30 Township 1N Range 32E
 County Umatilla Date: September 18, 2009

Corner Designation: 1N32T1

Condition Report Only
 Not found
 Remonumented
 Unrecorded
 Surveyed in
 Referenced out

Quarter corner to section 25, R31E, and Section 30, R32E, T1N, W.M., Umatilla County, Oregon

Previous Renewals / Surveys, etc.

Corner originally set by Josiah A. Burnett under contract No. 92 Dated September 12, 1860. His record reads: Set a post for 1/4 sec. cor., drove charred stake and raised mound with trench as per instructions. Geary Kimbrell in survey Q-52-Ax says: Stone.

Monument and Accessories found: (condition and source)

None. The point falls in the center of a north south road at the south edge of a plowed field.

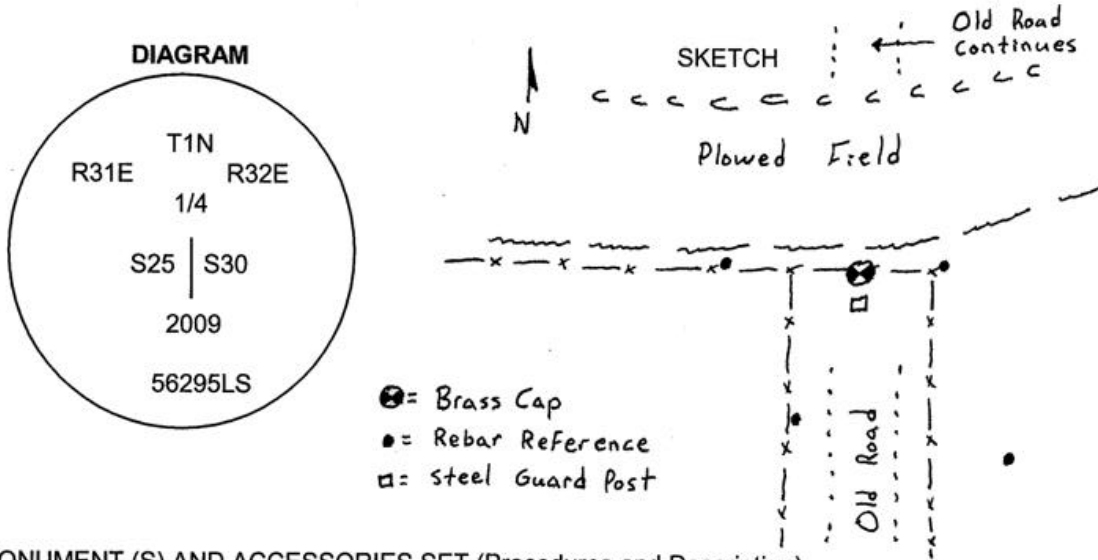

MONUMENT (S) AND ACCESSORIES SET (Procedures and Description)

Set a 1 1/2" x 30" Galvanized Iron Pipe with a 2 1/2" brass cap stamped as shown in the diagram above at the intersection of the road centerline running South and a fence running West. I set a 6' steel guard post with a monument sign 1' south of the monument.

For references, I set four 5/8" by 24" iron rebars with 1 1/4" orange plastic caps stamped WTS and 56295LS as described below:

- an iron rebar bears S87°35'49"W, 38.79 feet;
- an iron rebar bears S32°17'59"E, 88.82 feet;
- an iron rebar bears N83°48'39"E, 20.14 feet;
- an iron rebar bears S35°16'39"W, 32.22 feet;

The monument and references were tied using a Trimble R7/R8 RTK GPS system.

Location and comments
 NAD 83/1991 State Plane Coordinate
 Oregon North Zone
 N = 686,126.71 ift
 E = 8,619,358.80 ift

Compass Declination

Surveyors Seal

RECEIVED BY:
Umatilla County Surveyor
 Date: 6-10
 Rec'd By: KK
 No. 10-930

Firm / Agency
 Witness Tree Surveying
 Address
 P.O. Box G
 Pilot Rock, Or. 97868
 Party Chief
 Stephen K, Haddock

REGISTERED
 PROFESSIONAL
 LAND SURVEYOR

Stephen K. Haddock

OREGON
 JULY 9, 2001
 STEPHEN K. HADDOCK
 56295LS

RENEWAL DATE 6-30-11