

TOMKINS LAND SURVEYING, INC.
20 EAST POPLAR, SUITE 204
WALLA WALLA WA 99362
PHONE: 509/522-4843
FAX 509/522-1902
email: tomkins@wwics.com

JUNE 17, 1998

HORIZONTAL CONTROL DATA

STA. NAME: 912

LOCATION: TOWNSHIP 5 NORTH, RANGE 35 EAST, WILLAMETTE MERIDIAN. S.E. QUARTER OF SECTION 11.

DESCRIPTION: P.P. & L. BRASS CAP SET IN CONCRETE STAMPED "1515 1928", THERE IS A WHITE WOOD POST 3' SOUTH AND FIELD LINES RUN NORTH, SOUTH AND EAST.

GEODETIC COORDINATE: NAD 83(91)

LAT: 45°55'20.84982" N.

LONG: 118°24'40.94680" W.

STATE PLANE COORDINATE: NAD 83(91) OREGON NORTH ZONE (3601)

N: 252770.105 METERS

E: 2661996.619 METERS

N: 829298.245 INT. FEET

E: 8733584.710 INT. FEET

ELEVATION: 461.66 METERS

1514.63 FEET

ELEVATION DATUM: NAVD 88

THETA: 1°28'52.4"

GRID FACTOR: 0.999981209

SEA LEVEL FACTOR: 0.999927556

COMBINED SCALE FACTOR: 0.999908766

CONVERSION:

METERS X 3.28083333333 = U.S. FEET

METERS X 3.28083989501 = INTERNATIONAL FEET

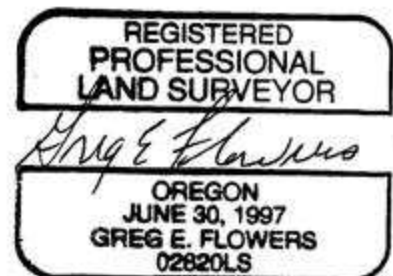

RENEWS 12/31/99

6/17/98