

NOTE:
 BEARINGS ARE BASED ON DATA FOR USC & G.S. STATIONS "ADAMS" AND "COLD SPRINGS". BEARINGS AND DISTANCES SHOWN ARE TRUE.
 THIS SURVEY IS NOT A COMPLETE SUB-DIVISION OF THIS SECTION, ONLY MONUMENTS SET WERE THOSE TIED TO MONUMENTS FOUND AS NOTED

LEGEND:
 ○ INDICATES MONUMENTS FOUND
 ⊙ INDICATES MONUMENTS SET AS NOTED
 () OF RECORD

REFERENCE:
 FILED TOWN PLAT FOR "ADAMS" SURVEYOR JOHN C. ARNOLD - 1883
 GLO FIELD NOTES
 FIELD DATA
 UMATILLA COUNTY SURVEY RECORDS

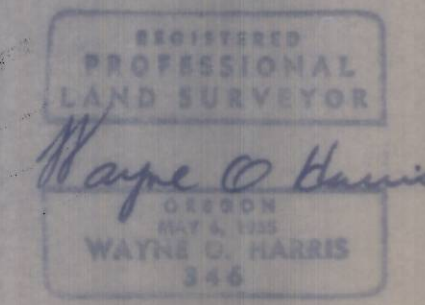

RECEIVED BY
 Umatilla County Surveyor
 Date 6-8-78
 Rec'd By M.S.J.
 No. 2-1122-C

REMONUMENTATION
 TOWN OF ADAMS, OREGON
 SEC. 4, T.3N., R.34E., W.M.

WAYNE HARRIS CO., Inc.				
ENGINEERS - SURVEYORS				
SCALE	DATE	DWG	CHK	DWG NO.
1"=400'	12-28-78	10	W.O.H.	78-532C