

NARRATIVE

The purpose of this survey is to locate the boundaries of McNary Mobile Manor Tract.

The boundary was established based on found monuments for McNary Townsite, Divisions No. 3 and 5.

Bearings are based on the plats of McNary Townsites.

Lewis Street, Chirook Street, Columbia Boulevard, Willamette Avenue, and Second Avenue are dedicated to the public as "Permanent Easements" on Page 533 of Book 355 of the Deed Records of Umatilla County, recorded March 30, 1976. They are under the jurisdiction and to be maintained by the City of Umatilla, Oregon.

- o denotes railroad spike found, except as noted
- denotes 1/2 in. iron pin set
- () denotes bearing or distance of record

RECEIVED BY
 Umatilla County Surveyor
 Date 9-81
 Rec'd By BLS
 No. S-120-B

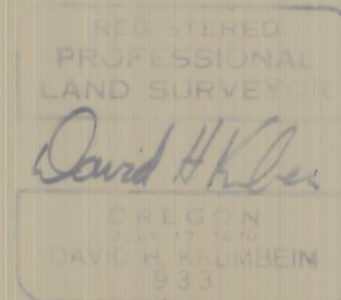

K KRUMBEIN ENGINEERING CO. ENGINEERS - SURVEYORS - PLANNERS 221 S. Main, Pendleton, Oregon	SCALE 1" = 100'
	DATE Sept. 1, 1981
Survey for McNARY MOBILE MANOR	
located in Section 15, T5N, R28E, W1M.	
DRN BY NA	DRNG NO 81-36C
CKD BY D.H.K.	