

60

60

N. W. Furnish Ave.

60

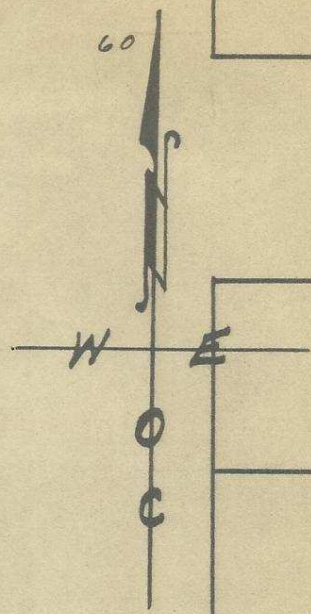
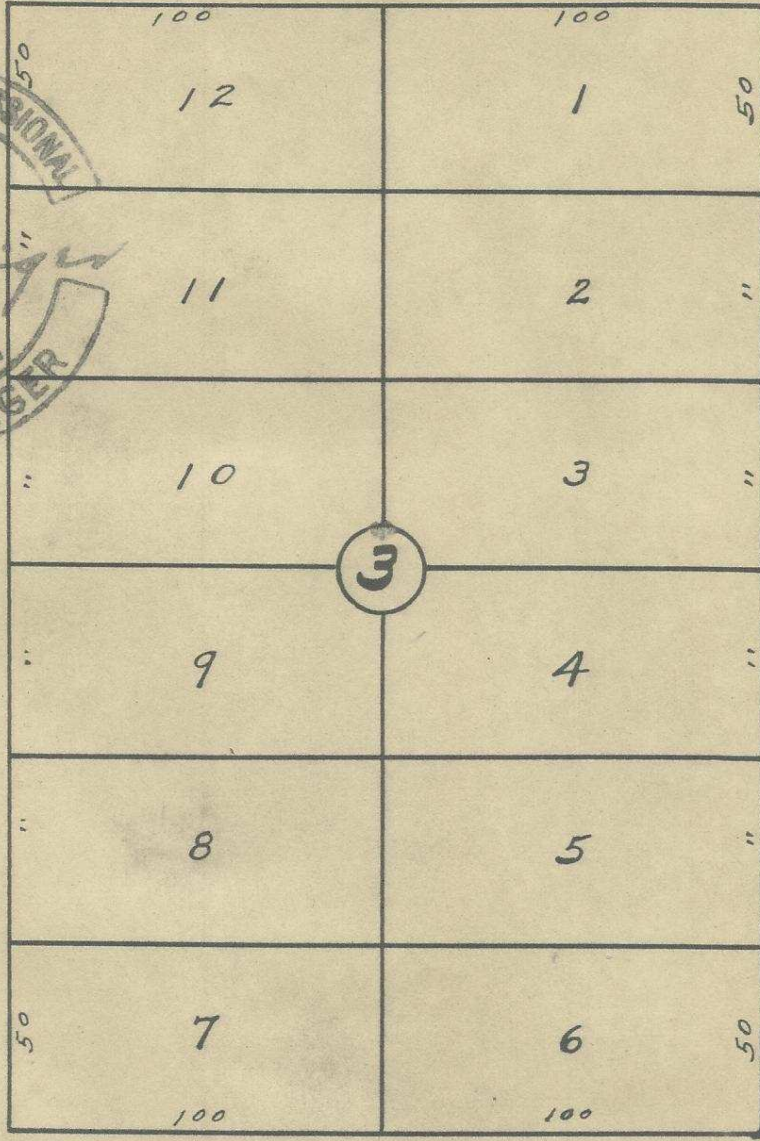
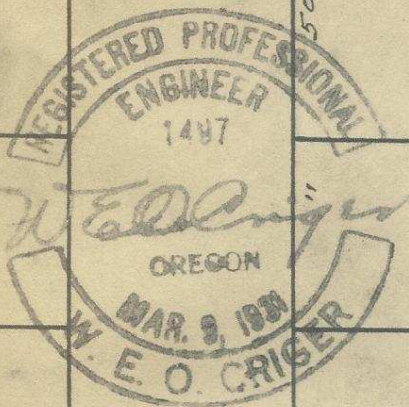

N. W. 4th St.

N. W. 3rd St.

N. W. Ellis Ave.

2N32 3DD

Plat showing  
Block 3 of Switzers  
Addition to Pendleton, Ore.  
Surveyed, staked & platted,  
Dec. 1948 - By W. E. O. Criger  
Scale: 1 inch = 50 Feet.  
For Dr. Louis J. Foyes.

06-113-Ax