



Scale 1" = 500 ft.

Narrative

The purpose of this survey, at the request of Manuel Correa is to locate the South line of Sec. 8 T. 3N., R29 E.W.M. and to set line pins at intervisible positions on said line. I did this by setting the instrument off line and locating its position from two sets of angles and distance intersections. I then traversed close to the section line and doubled in the pins as shown.

A topcon GTS 2B Geodetic Total Station was used on this survey.

The basis of bearing is from Station Stanfield East Base Preliminary Data as used on C.S. 1-202-AX

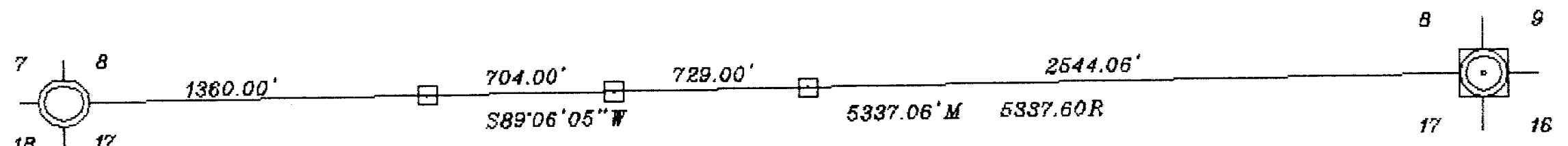

BASIS OF BEARING FROM C.S. 1-202-AX

Found 2" Br. Cap stamped
Umatilla County Surveyor
Origin unknown

Found 3 1/2" Br. Cap stamped
P.L.S. 933, C.S. 1-202-AX

Legend

- Set 5/8" by 30" rebar with plastic cap stamped P.L.S. 348

REGISTERED
PROFESSIONAL
LAND SURVEYOR

Wayne O. Harris

OREGON
WAYNE O. HARRIS
#346

WAYNE HARRIS CO. INC.
P.O. BOX 666 PENDLETON, ORE.
541-276-7642

Survey for Manuel Correa, to locate and set line pins on South line of Sec 8, T. 3N., R. 29E.W.M.

dwg. tj chk wnh date 2/2/98 # 98-02

RECEIVED BY
Umatilla County Surveyor
Date 3-98
Rec'd By KK
No. 98-23-A

98-23-A