

# Town of North Milton

Situated on N. 1/2 of SE 1/4 of Sec. 2, T. 5, N. R. 35 E.  
Umatilla County, Oregon

The N-S line through the center of the S.E. 1/4 of the said Sec. 2 is taken as a standard base. All streets are located parallel to and right angles to it.  
The small red and black figures indicate the length of lines on which they are written in black.

I hereby certify that the following is a correct plat of the town of North Milton as surveyed by me during the month of October, A.D. 1885  
Geo. C. Atwell Surveyor

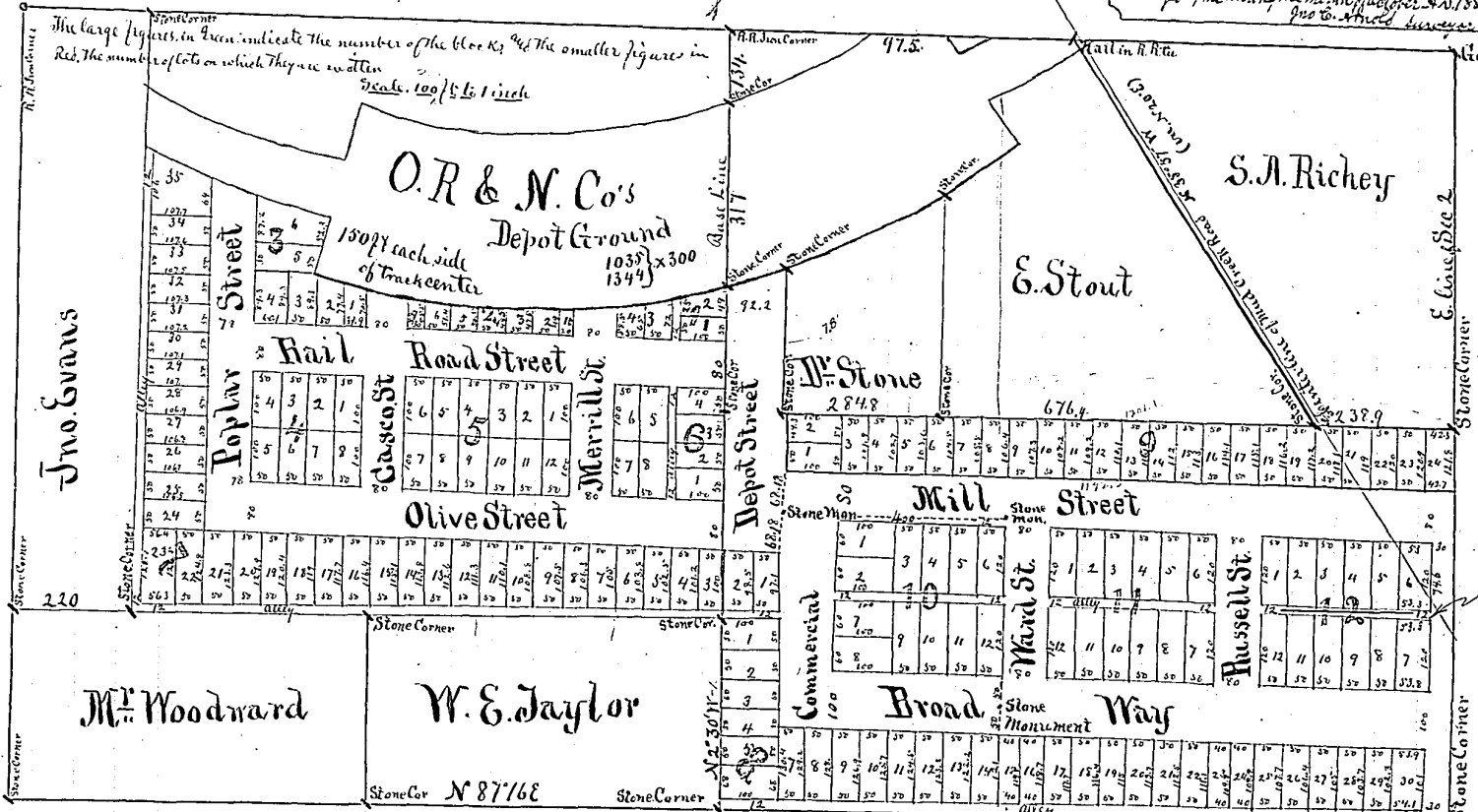

Vacated by  
Ord. No. 39  
Sept. 27, 1962  
B 267  
R 645 265

Filed Oct 23<sup>rd</sup> 1888 at 11.0 o'clock A.M.

J.P. Bushie Clerk.