

# Jacob's Addition to Pendleton

Survey beginning at a point about 1/4 of a mile East of corner of Sections 2-3-10+11 S. 2 N. R. 32 East and opposite of the U. S. Col. College Block in town of Pendleton Court, Oregon, Sec. & Turner Streets 60 ft wide Lewis Street 50 ft wide Lots in Blks 1-2-3+4 - 50x100 feet. Lots in Blks. A+B. 50 ft. on Lewis Street and extending North to Amalilla River.

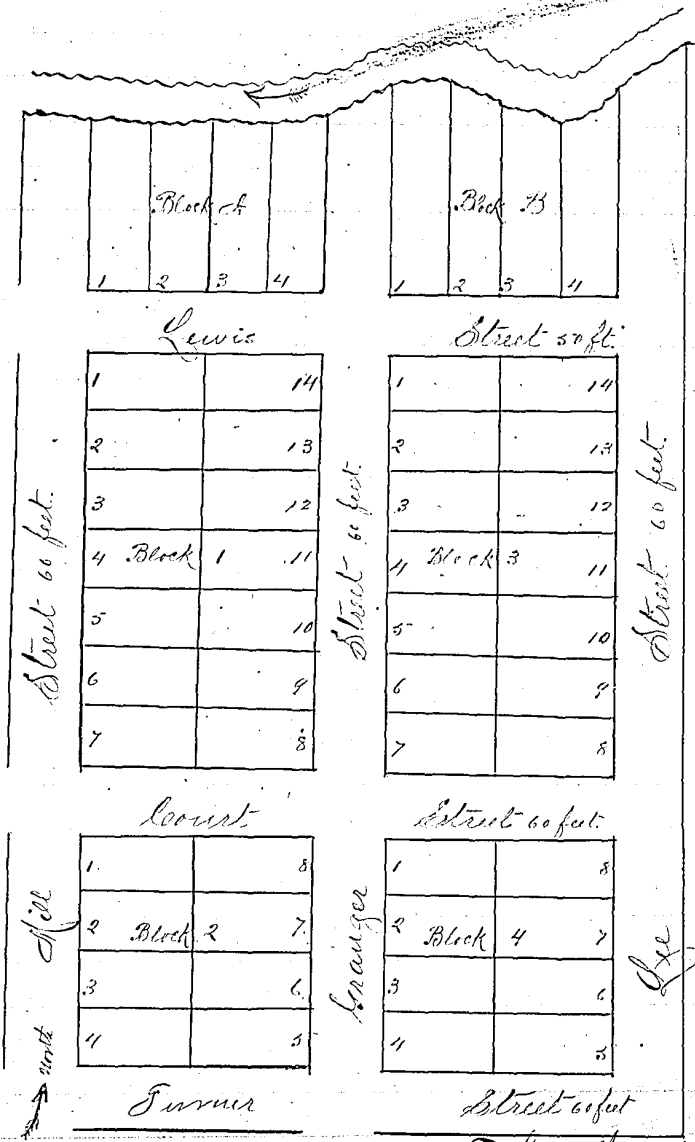

J. L. Moorhouse  
Surveyor.

Filed for Record Dec. 21, 1877.  
J. N. Shanon  
Clerk

ford  
ation  
have  
con-  
wit:  
two  
other  
spun  
with  
of  
nces,  
ed  
to be  
from  
me  
this  
lly  
to be  
ten  
e