

PLAT OF
OLYMPIC PARK SUBDIVISION
OF
STANFIELD ORCHARD OUT-LOTS
Numbers 1 to 7 and 156 to 165
Part of the S.E. 1/4 of Sec 32 T. 4 N. R. 29 E.
Umatilla County, Oregon.
Scale 1 inch = 100 Feet.

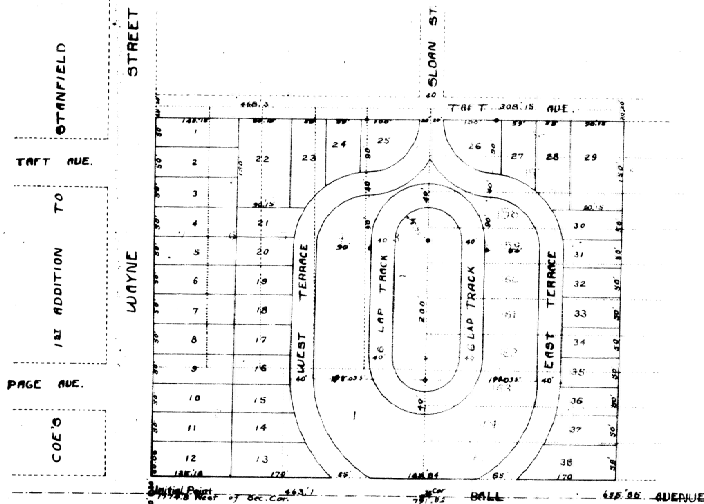

Know All Men By These Presents, That the Columbia Land Company, an Oregon Corporation, being the owner of the Land included in the Plat hereon, and it has caused the same to be plotted as the Olympic Park Subdivision of Stanfield Orchard Out-Lots, Numbers 1 to 7 and 156 to 165, as said Out-Lots are shown on the Plat hereby recorded in the County Records of Umatilla County, Oregon; and same is situated in the Southeast quarter of Sec. 32, T. 4 N. R. 29 E. W.M., in Umatilla County, Oregon, hereby dedicating to the use of the public all streets and avenues shown thereon, without reservation.

In Witness Whereof we have hereunto set our hand and affixed the seal of said Company, this 6th day of January, 1911.
Executed in presence of
R. M. Tuttle
Columbia Land Company
Henry W. Coe
President.

State of Oregon } ss
County of Multnomah }

On this 6th day of January, 1911, before me appeared Henry W. Coe, to me personally known, who being duly sworn, upon oath says, that he is President of the Columbia Land Company, the Corporation above named; that the deed affixed to the foregoing instrument is the act of said Corporation, and that said instrument was signed and sealed in behalf of said Company by authority of its board of Directors, and said Henry W. Coe acknowledged said instrument to be the free act and deed of said Corporation.
In Testimony Whereof, I have hereunto set my hand and affixed my Notarial Seal the day and year last above written.
R. M. Tuttle
Notary Public for Oregon.

State of Oregon } ss
County of Umatilla }

AFFIDAVIT OF SURVEY

C. D. Porter being duly sworn, upon oath says, that he is the Surveyor who surveyed the Olympic Park Subdivision of Stanfield Orchard Out-Lots Nos. 1 to 7 and 156 to 165 and same is correctly marked on the ground by proper stakes and monuments as represented upon the annexed Plat of said Subdivision; that at the Initial Point of this survey he established a proper monument, the same being a galvanized iron pipe two inches in diameter and three feet long and driven in the ground so that top end thereof is six inches below the surface of the ground, which Initial Point and Monument is located on the South line of Sec. 32 T. 4 N. R. 29 E. W.M., at its intersection with the East line of Wayne Street in Coe's First Addition to the Town of Stanfield and 1776.8 feet West of the Southeast corner of said Section, and that all dimensions of said subdivision are marked on said plat in feet and decimal parts of a foot, and said land included in said plat are a part of the Southeast quarter of said Section 32, in Umatilla County, Oregon.
C. D. Porter
Surveyor.

Subscribed and Sworn to before me this 6th day of January, 1911.
Angela W. Long
Notary Public for Oregon.

State of Oregon } ss
County of Umatilla }

We have examined this Plat of Olympic Park Subdivision of certain Stanfield Orchard Out-Lots and hereby approve same finding that the same adopted is proper, that streets and Avenues are dedicated without reservation to the use of the public and conform with those of adjoining plats, and that all taxes and assessments have been paid on lands included therein.
Dated at Pendleton, Oregon, January 11, 1911.

Henry W. Coe
County Surveyor
Frank S. Galt
County Sheriff
William
County Treasurer

State of Oregon } ss
County of Umatilla }

I hereby certify that the attached plat of Olympic Park Subdivision of certain Stanfield Orchard Out-Lots has been approved by the County Court of said County and State, by order made and entered on the 11th day of January, 1911.
Frank S. Galt
County Clerk and of Office
Clerk of the County Court of
Umatilla County, Oregon.

1911
This plat was filed for record in the County Records of Umatilla County, Oregon, on the 11th day of January, 1911.
Witness my hand and the seal of said County at Pendleton, Oregon, this 11th day of January, 1911.
Frank S. Galt
County Clerk

BOOK 17

BOOK 17