

### Stafford's Addition to the Town of Athena in Umatilla County, Oregon.

I hereby certify that at the request of A. M. Stafford of Athena, Oregon, I did, on the 17<sup>th</sup> day of April A. D. 1889, survey Stafford's Addition to Athena, in Umatilla County, Oregon, the following is a correct plat of the same.  
Jno. C. Arnold, Surveyor.

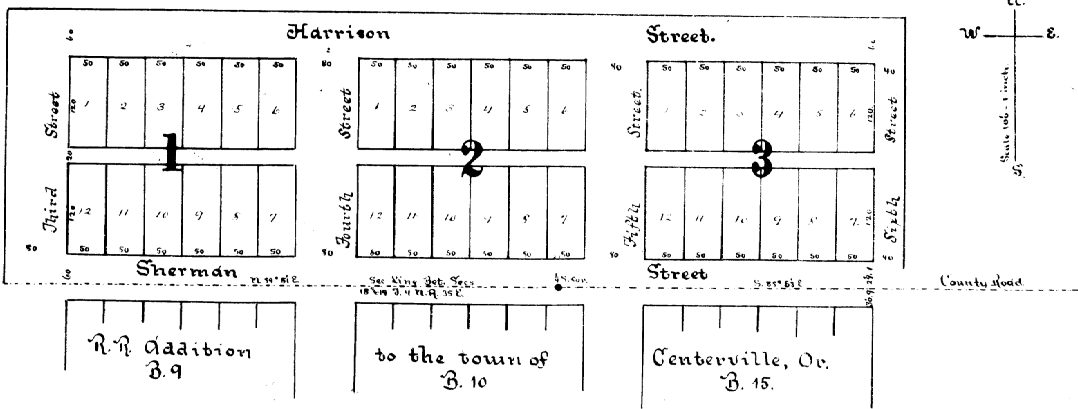

Filed May 9<sup>th</sup> 1889  
G. A. Hartman  
Clerk.