

See Page 31

See Page 40

R31

See Page 41

R32

ROAD 10 & 275;  
MARKET ROAD NO. 47  
WIDTH = 60'

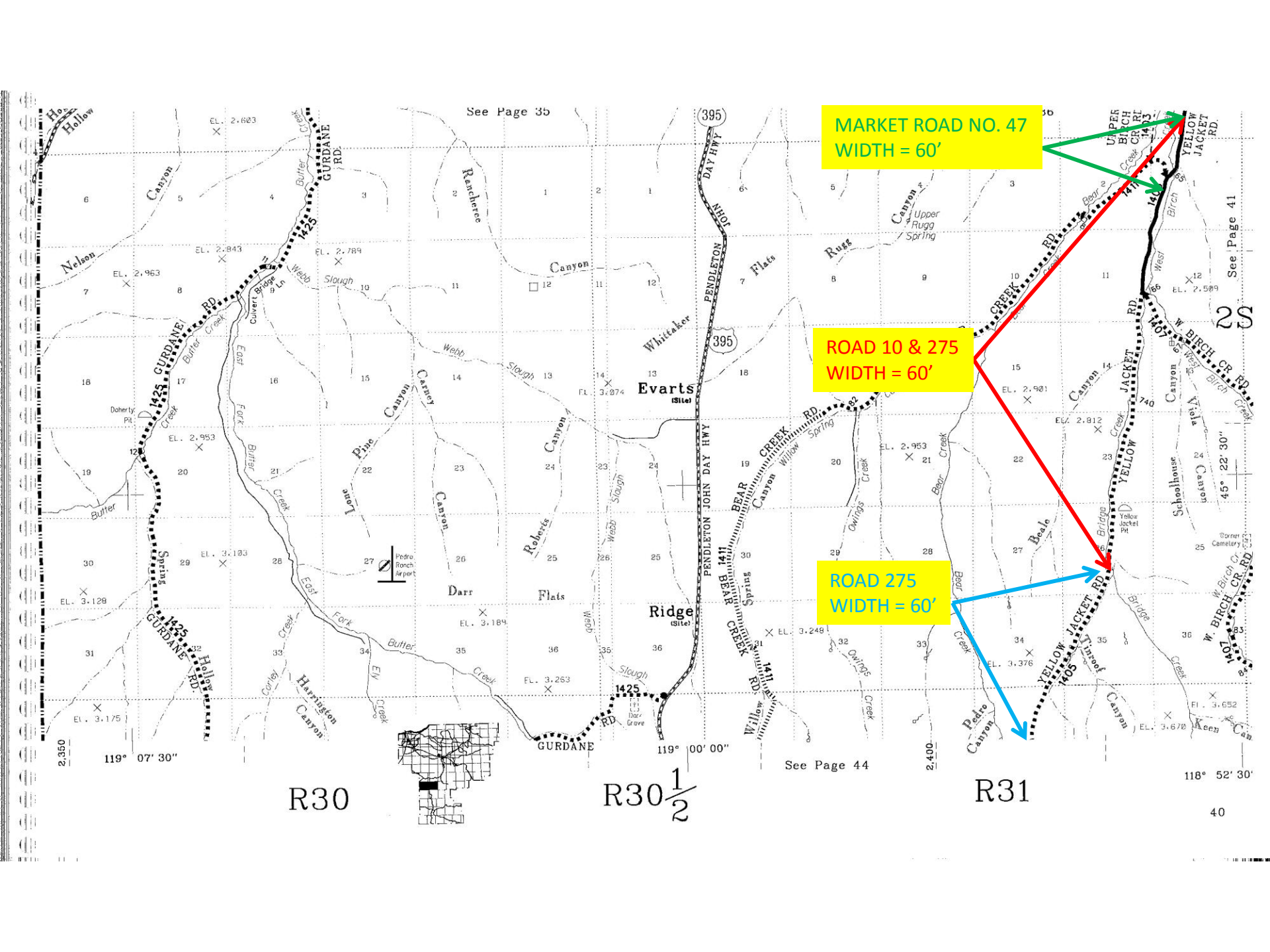

See Page 35

MARKET ROAD NO. 47  
WIDTH = 60'

ROAD 10 & 275  
WIDTH = 60'

ROAD 275  
WIDTH = 60'

See Page 41

See Page 44

R30

R30 1/2

R31

119° 07' 30"

119° 00' 00"

118° 52' 30"

2,350

2,400



2S

45° 22' 30"

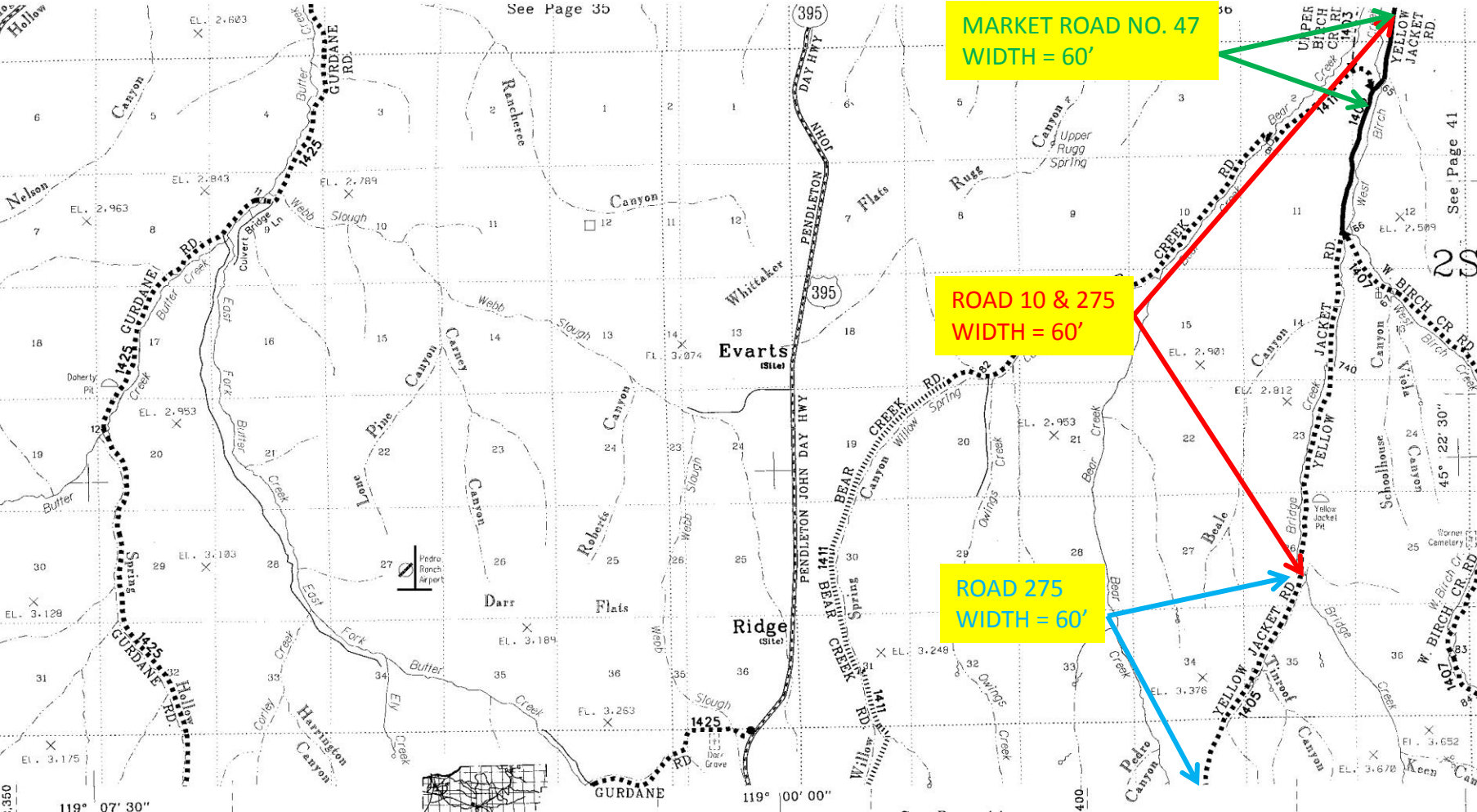

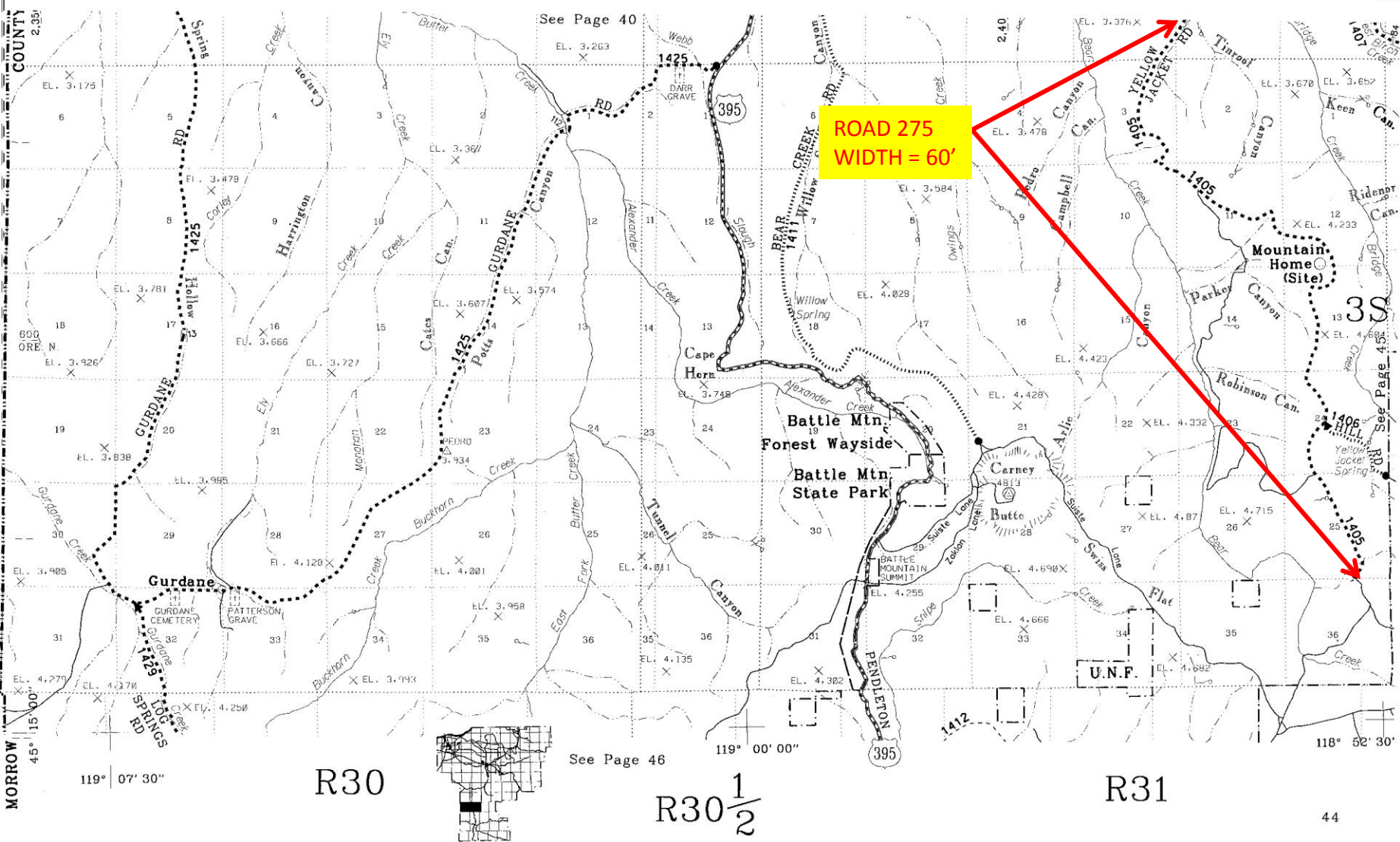

See Page 40

See Page 45

See Page 46

MORROW COUNTY 2.95'

119° 07' 30"

R30

R30 1/2

R31