

U.S. 30 JCT-MEADOWS JCT
WIDTH VARIES

ROAD 375 CHANGE
WIDTH = 40'

ROAD 375
WIDTH = 60'

ROAD 665
WIDTH = 60'

?

?

See Page 9

1349
VEY RD



R29

See Page 13

R30

10

See Page 11

3N

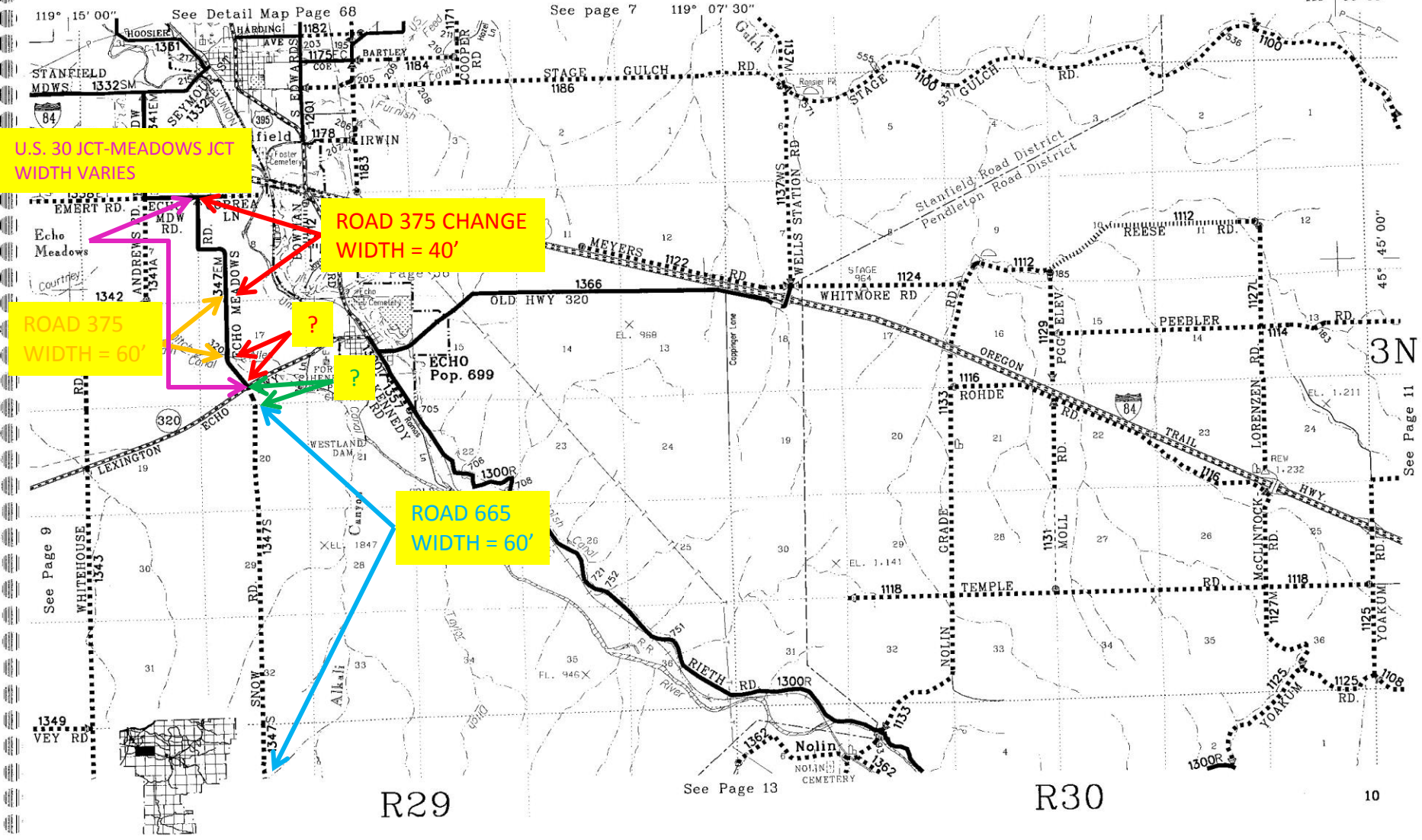

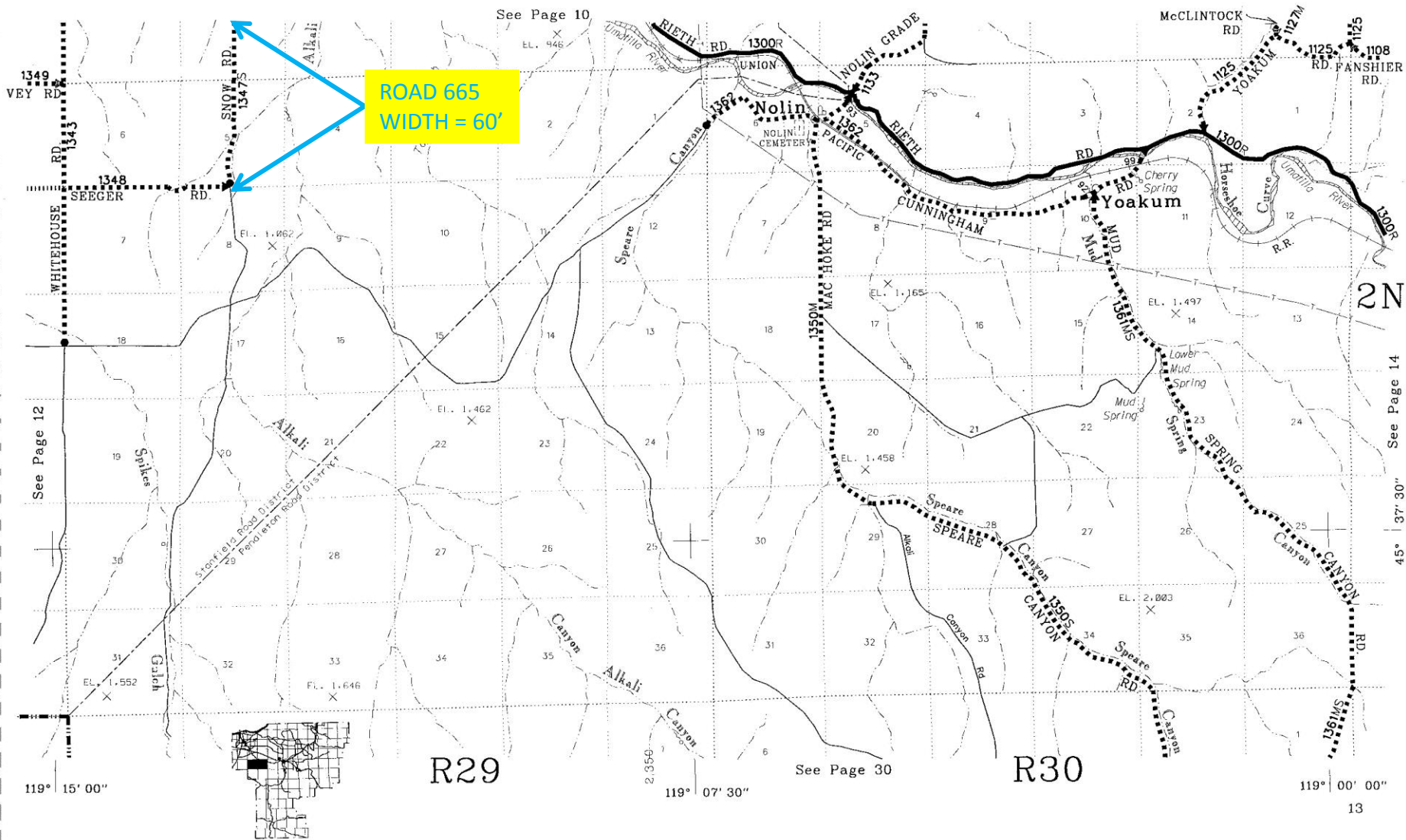

ROAD 665
WIDTH = 60'

R29

R30