

BY DEED
WIDTH VARIES

ROAD 265
WIDTH = 60'

MARKET ROAD 42
WIDTH = 60'

R31

R32

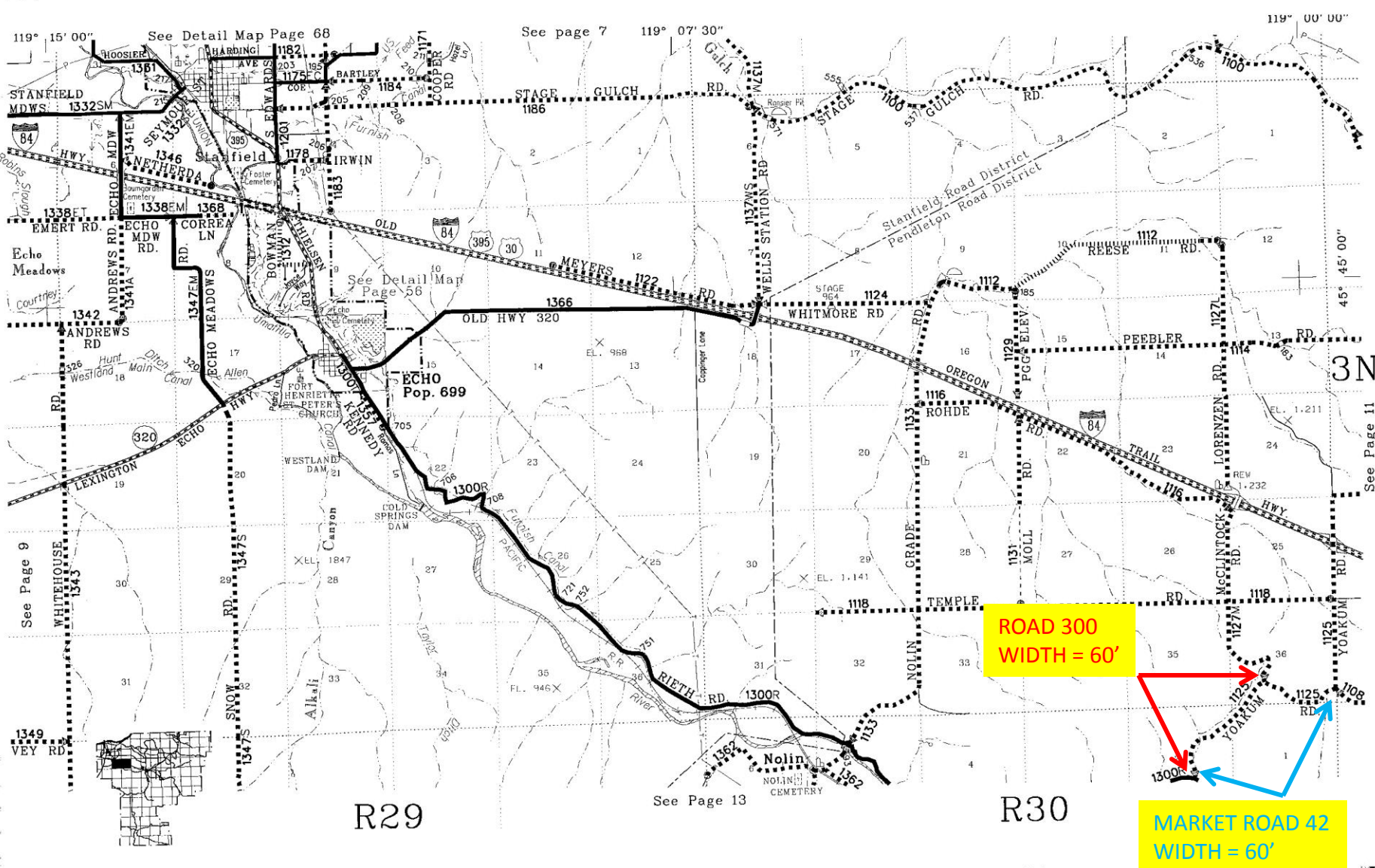

119° 15' 00"

See Detail Map Page 68

See page 7

119° 07' 30"

119° 00' 00"

STANFIELD MDWS 1332SM

STAGE GULCH RD 1186

STAGE GULCH RD 100

HWY 84

1346 NETHERDA

1178 CIRWIN

EMERT RD 1338FT

1338EM

1368

ECHO MEADOWS

1347EM

1347M

ANDREWS RD 1342

1341A

1341A

ECHO MEADOWS

1347M

1347M

ANDREWS RD 1342

1341A

1341A

ANDREWS RD

1342

1342

ANDREWS RD

1342

1342

ANDREWS RD

1342

1342

ANDREWS RD

1342

1342

ANDREWS RD

1342

1342

ANDREWS RD

1342

1342

ANDREWS RD

1342

1342

ANDREWS RD

1342

1342

ANDREWS RD

1342

1342

ANDREWS RD

1342

1342

ANDREWS RD

1342

1342

ANDREWS RD

1342

1342

ANDREWS RD

1342

1342

ANDREWS RD

1342

1342

ANDREWS RD

1342

1342

ANDREWS RD

1342

1342

ANDREWS RD

1342

1342

ANDREWS RD

1342

1342

ANDREWS RD

1342

1342

ANDREWS RD

1342

1342

ANDREWS RD

1342

1342

R29

See Page 13

R30

ROAD 300
WIDTH = 60'

MARKET ROAD 42
WIDTH = 60'

See Page 11

3N



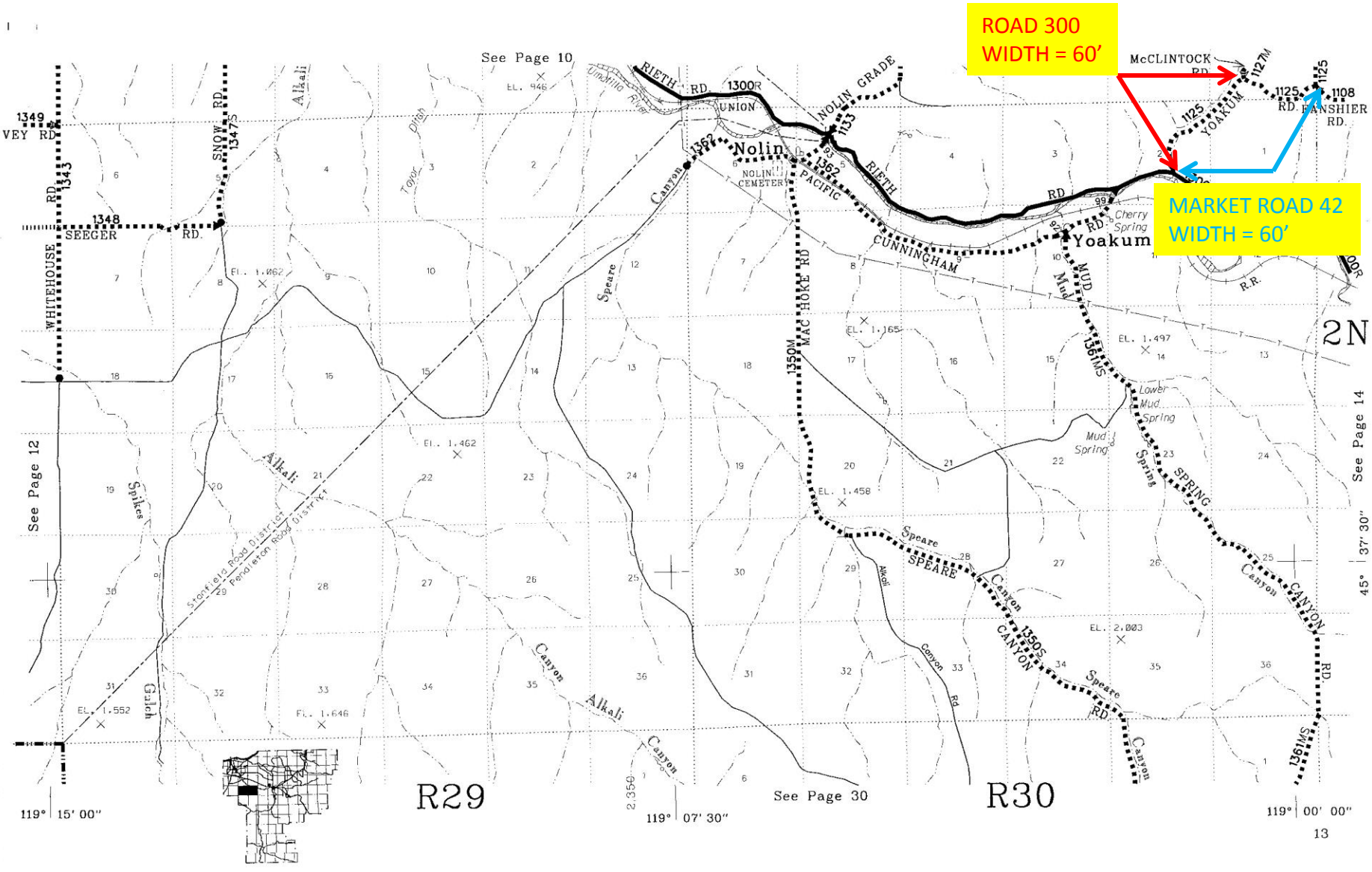

**ROAD 300
WIDTH = 60'**

**MARKET ROAD 42
WIDTH = 60'**

1349
VEY RD

1348
SEEGER RD

WHITEHOUSE RD
1343

SNOW RD
1347S

See Page 10
EL. 946

RIETH RD 1300R
UNION

Nolin
NOLIN CEMETERY

NOLIN GRADE
1333

CUNNINGHAM RD

Yoakum
Cherry Spring

McCLINTOCK RD
1125

1125
RD. FANSHIER RD
1108

See Page 12

Alkali
Storkley's Road District
Poplarville Road District

R29

See Page 30

R30

2N

See Page 14

45° 37' 30"

119° 15' 00"

119° 07' 30"

119° 00' 00"