

- Walker Rd 1231
- Westland Rd 1215WE
- 1st Pl (N) 1275-1
- 1st St (S) 1245-1
- 2nd St (NE) 1227
- 4th St (SE) 1193
- 9th St (SE) 1197
- 10th St (NE & SE) 1219
- 10th St (SW) 1297
- 11th St (NW) 1247
- 17th St (SW) 1189
- 23rd St (SW) 1238-23

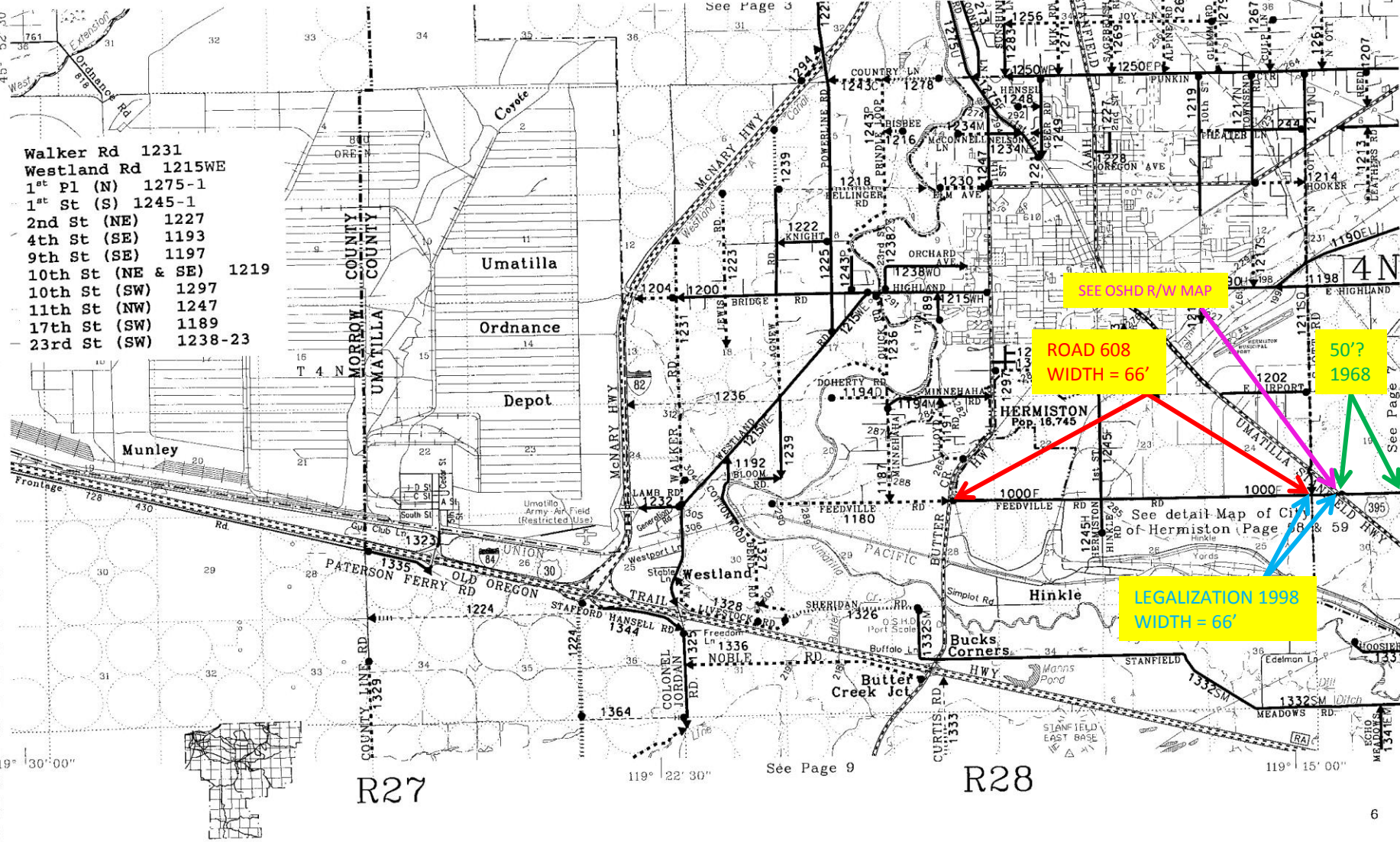

SEE OSHD R/W MAP

ROAD 608
WIDTH = 66'

50'?
1968

LEGALIZATION 1998
WIDTH = 66'

See detail Map of City
of Hermiston (Page 58 & 59)

R27

R28

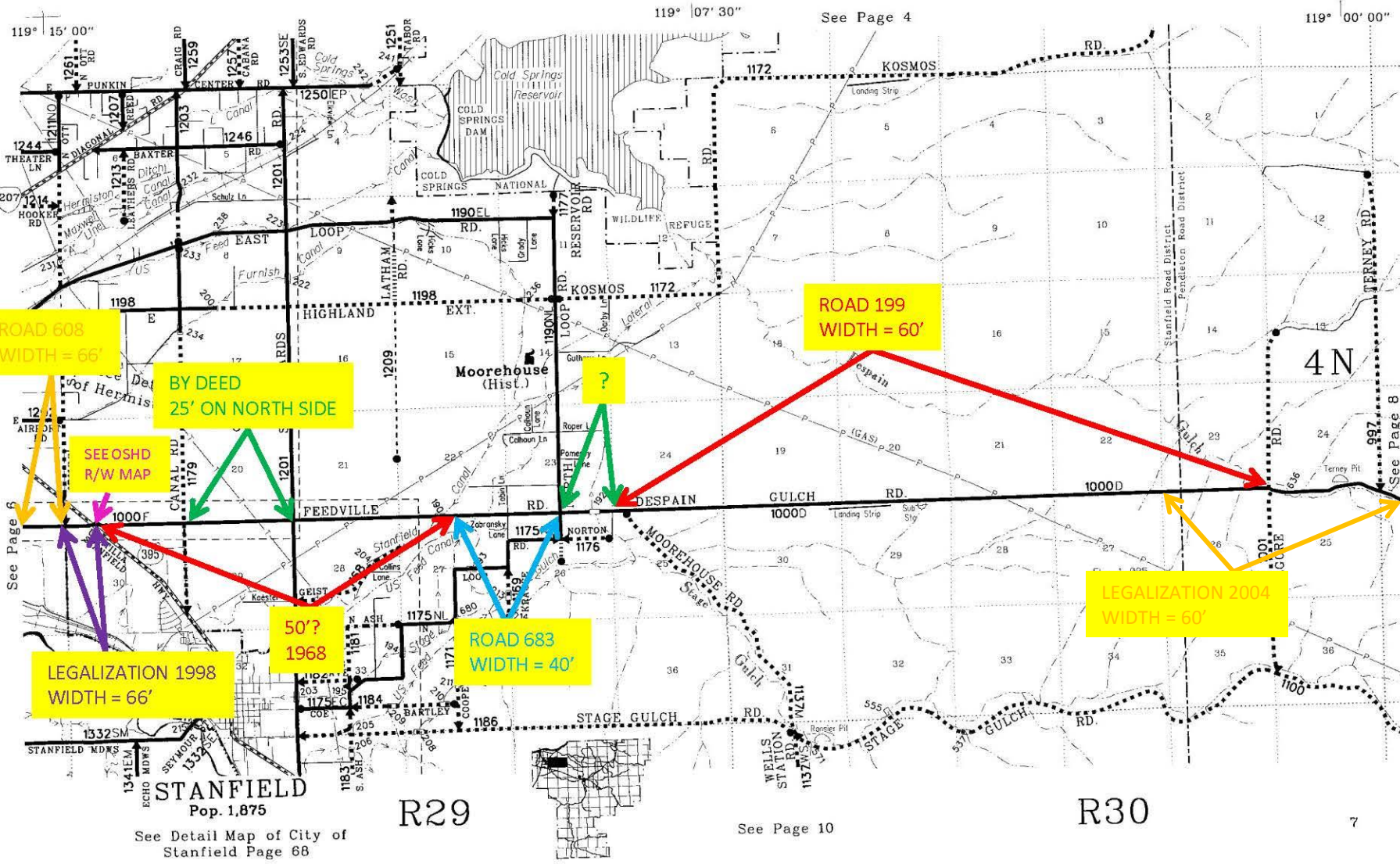

119° 15' 00"

119° 07' 30"

See Page 4

119° 00' 00"

ROAD 608
WIDTH = 66'

BY DEED
25' ON NORTH SIDE

SEE OSHD
R/W MAP

ROAD 199
WIDTH = 60'

LEGALIZATION 2004
WIDTH = 60'

LEGALIZATION 1998
WIDTH = 66'

50?
1968

ROAD 683
WIDTH = 40'

STANFIELD
Pop. 1,875
See Detail Map of City of
Stanfield Page 68

R29

See Page 10

R30

7

See Page 6

See Page 8

119° 00' 00"

118° 52' 30"

118° 45' 00"

15° 52' 30"

See Page 5

See Page 21

See Page 11

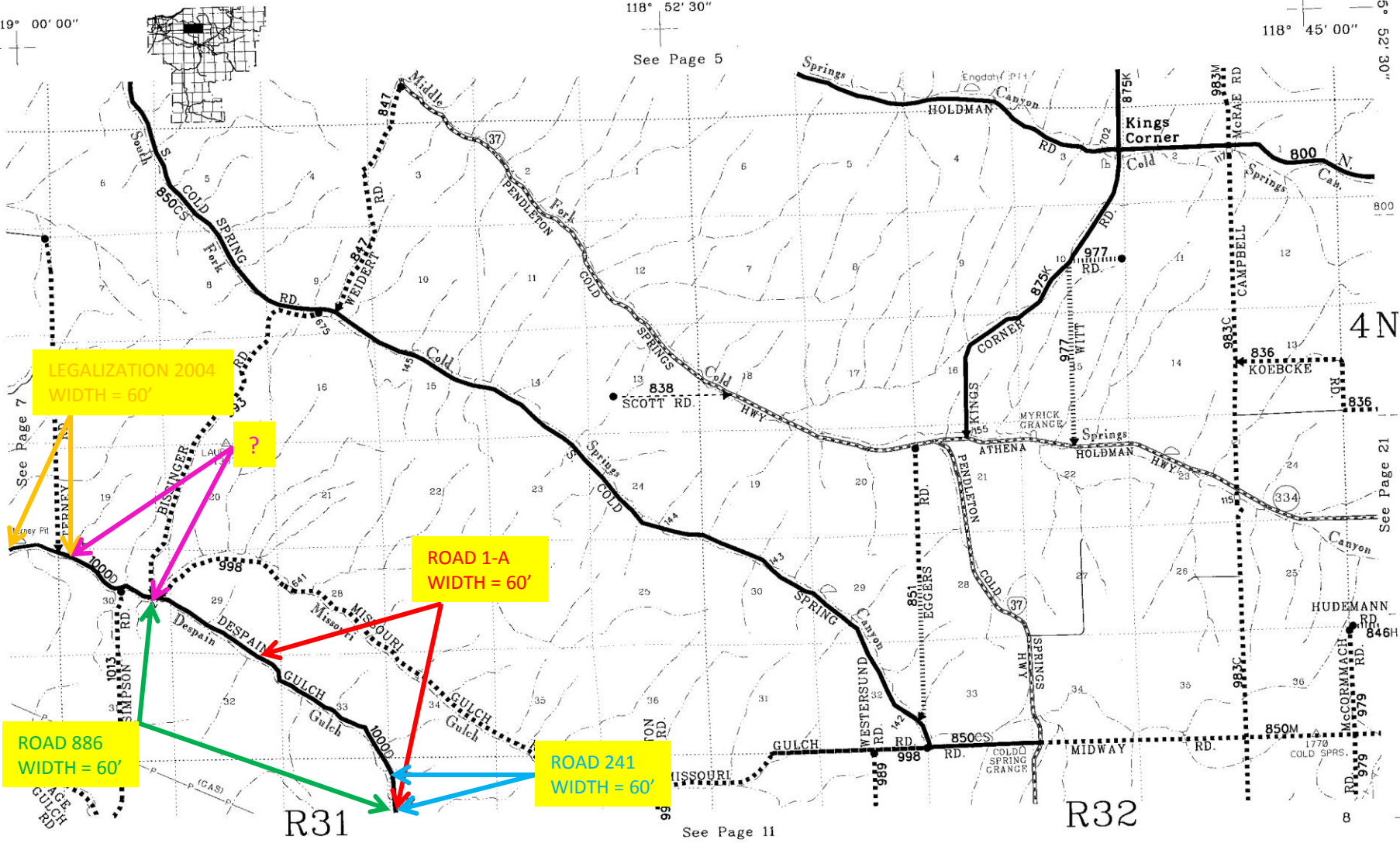

LEGALIZATION 2004
WIDTH = 60'

?

ROAD 1-A
WIDTH = 60'

ROAD 886
WIDTH = 60'

ROAD 241
WIDTH = 60'

R31

R32

4N

8

