

STATE OF OREGON     )  
                          )   ss  
County of Marion     )

I, H. B. Glaisyer, Secretary of the Oregon State Highway Commission, do hereby certify that the attached copy of -----

----- Abandonment and Retention ----- Resolution No.

319 , adopted by the State Highway Commission on -----

.. September 27 ....., 19 56 .. , abandoning certain portions

of the former right of way of the relocated Havana Section of the -----

Umatilla

Havana-Helix Highway No. 335 in ~~Sherman~~ County. -----

-----  
entered in Volume ---XLI----- of the minute book, wherein official acts of the said Oregon State Highway Commission are recorded, has been compared by me with the original resolution and that the same is a true and correct copy of said resolution and of the whole thereof.

IN WITNESS WHEREOF, I have hereunto set my hand and affixed the official seal of the Oregon State Highway Commission this -- 11th -- day of ----- October -----, 19-56-----.

  
Secretary  
OREGON STATE HIGHWAY COMM.



RESOLUTION

WHEREAS, the relocated Havana Section of the Havana-Helix Secondary Highway No. 335 located in Umatilla County, the northerly terminus of which is at Highway Engineer's Survey Station 2+00 and the southerly terminus of which is at Highway Engineer's Survey Station 51+94.04 on the relocated highway, has been completed and is now open for public travel; and

WHEREAS, due to the relocation of the aforesaid section, portions of the former right of way are no longer needed for right of way purposes and may be eliminated from the boundaries of the relocated highway; and

WHEREAS, Umatilla County and the State Highway Commission entered into an agreement on the 27th day of April, 1956, relating to the disposition to be made of the portions that may be eliminated, therein and hereinafter referred to as Units "A," "B," "C," and "D."

WHEREAS, said agreement provided that Units "A," "B," "C," and "D" would be abandoned by the State Highway Commission by a formal resolution as part of the Havana-Helix Highway and the state highway system; that Units "A" and "C" would be maintained thereafter by County as part of the county road system; and that Units "B" and "D" would revert to the owners of the abutting property; and

WHEREAS, it is the judgment of the Highway Commission that certain portions of the former right of way of the Havana Section of the Havana-Helix Highway, together with other real property acquired by the State for roadway right of way and other public purposes, is needed and valuable for right of way purposes and public use; and

WHEREAS, it is the purpose of the Highway Commission to take official action and impress upon its records the disposition made of the portions or units of the former right of way of the said Havana-Helix Highway referred to herein as Units "A," "B," "C," and "D" as well as all the property affected by reason of said realignment;

NOW, THEREFORE, BE IT AND IT HEREBY IS RESOLVED by this Commission as follows:

1. That the portions of the former right of way which by reason of the relocation of the Havana Section of the Havana-Helix Highway are no longer within the boundaries of the new right of way are identified as Units "A," "B," "C," and "D," and described as follows:

Unit "A"

All the land situated within the right of way boundaries of the Havana-Helix Highway as formerly routed, beginning at the westerly right of way line opposite Highway Engineer's Survey Station 6+50 of the said highway as relocated in the northeast quarter of the northwest quarter ( $NE\frac{1}{4}$   $NW\frac{1}{4}$ ), Section 23, Township 3 North, Range 33 East, W. M.; thence southwesterly via said highway as formerly routed to a county road junction in the southeast quarter of the northwest quarter ( $SE\frac{1}{4}$   $NW\frac{1}{4}$ ), Section 23, Township 3 North, Range 33 East, W. M.

Unit "B"

All the land situated within the right of way boundaries of the Havana-Helix Highway as formerly routed beginning at a county road junction in the southeast quarter of the northwest quarter ( $SE\frac{1}{4} NW\frac{1}{4}$ ), Section 23, Township 3 North, Range 33 East, W. M.; thence southerly via said highway as formerly routed to the northerly right of way line of the Union Pacific Railroad in the northeast quarter of the southwest quarter ( $NE\frac{1}{4} SW\frac{1}{4}$ ), Section 23, Township 3 North, Range 33 East, W. M.

Unit "C"

All the land situated within the right of way boundaries of the Havana-Helix Highway as formerly routed beginning at the southerly right of way line of the Union Pacific Railroad in the northeast quarter of the southwest quarter ( $NE\frac{1}{4} SW\frac{1}{4}$ ) of Section 23, Township 3 North, Range 33 East, W. M.; thence easterly and north-easterly via said highway as formerly routed to the east-west center line of Section 23, Township 3 North, Range 33 East, W. M.

Unit "D"

All the land situated within the former right of way boundaries of the Havana-Helix Highway as formerly routed, beginning at the easterly right of way line opposite Highway Engineer's Survey Station 48+70 of said highway as relocated in the northwest quarter of the northeast quarter ( $NW\frac{1}{4} NE\frac{1}{4}$ ), Section 26, Township 3 North, Range 33 East, W. M.; thence easterly via said highway as formerly routed to the northerly right of way line opposite Highway Engineer's Survey Station 327+80.3 of the Oregon-Washington Highway No. 8 in the northwest quarter of the northeast quarter ( $NW\frac{1}{4} NE\frac{1}{4}$ ), Section 26, Township 3 North, Range 33 East, W. M.

2. That pursuant to the agreement entered into with Umatilla County on the 27th day of April, 1956, Units "A," "B," "C," and "D" indicated on the map attached hereto and marked Exhibit "A," and by this reference made a part hereof, are hereby duly abandoned as part of the Havana-Helix Highway and the state highway system; all right, title, and interest which State has in the right of way of Units "A" and "C" herein described, pass to and vest in the said County; and all right, title, and interest which State has in the right of way of Units "B" and "D" herein described, pass to and vest in the abutting property owners.
3. That the right of way of the former and of the relocated Havana Section of the Havana-Helix Highway, together with the real property acquired by State for roadway right of way and other public purposes, as indicated and colored in green on Exhibit "A" attached hereto, shall be retained and held by State.
4. That this Abandonment & Retention Resolution, No. 319 be entered in the minutes and records of the Oregon State Highway Commission as of the 27th day of September, 1956, and that the Secretary is ordered to mail a duly certified copy hereof to the County Court of Umatilla County.

T.3 N., R.33 E., W.M.

N. End of Project  
Sta. 2+00

6+50

UNIT "A"

UNIT "B"

UNIT "C"

UNIT "D"



S. End of Project  
Sta. 51+94.04

327+80.3

22 23

# EXHIBIT "A"

## HAVANA SECTION HAVANA - HELIX HWY. Umatilla County Sept. 1955

-  To be retained by State
-  To be abandoned to County
-  To be abandoned to abutting property.

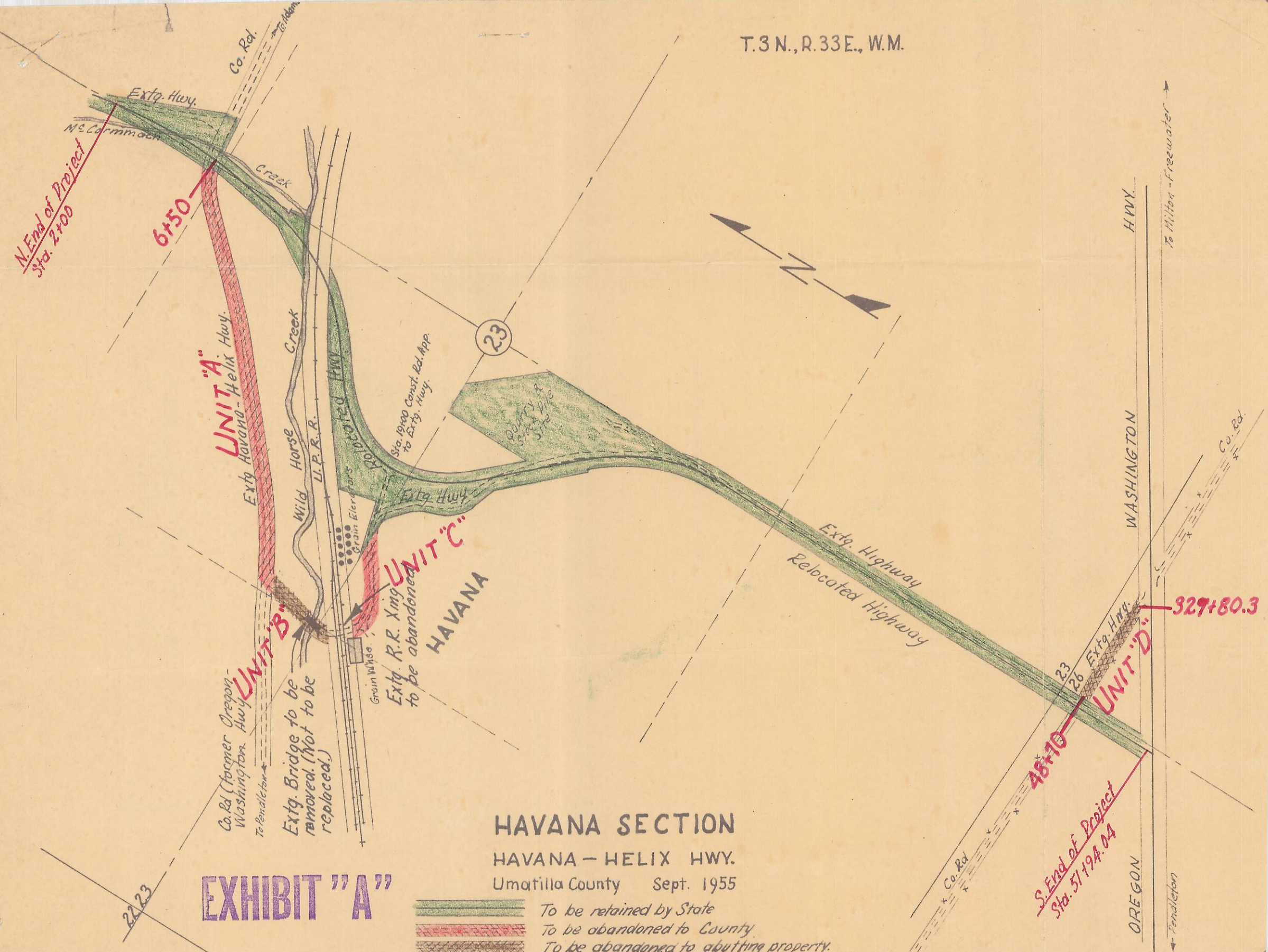

Extg. Havand - Helix Hwy.

Co. Rd (former Oregon - Washington Hwy.)  
To Pendleton

Extg. Bridge to be removed. (Not to be replaced.)

Wild Horse Creek

L.P.R.R.

Grain Elevators

Grain Wharf

Sta. 1940 Const. Rd. App. to Extg. Hwy.

HAVANA

23

Extg. Highway  
Relocated Highway

WASHINGTON

OREGON

HWY.

To Pendleton

To Milton - Freewater

Co. Rd.