

See Page 2

**ROAD 112
WIDTH = 60'**

R33

**LEGALIZATION 2004
WIDTH = 60'**

See Page 18

R34

LEGALIZATION 2004
WIDTH = 60'

ROAD 112
WIDTH = 60'

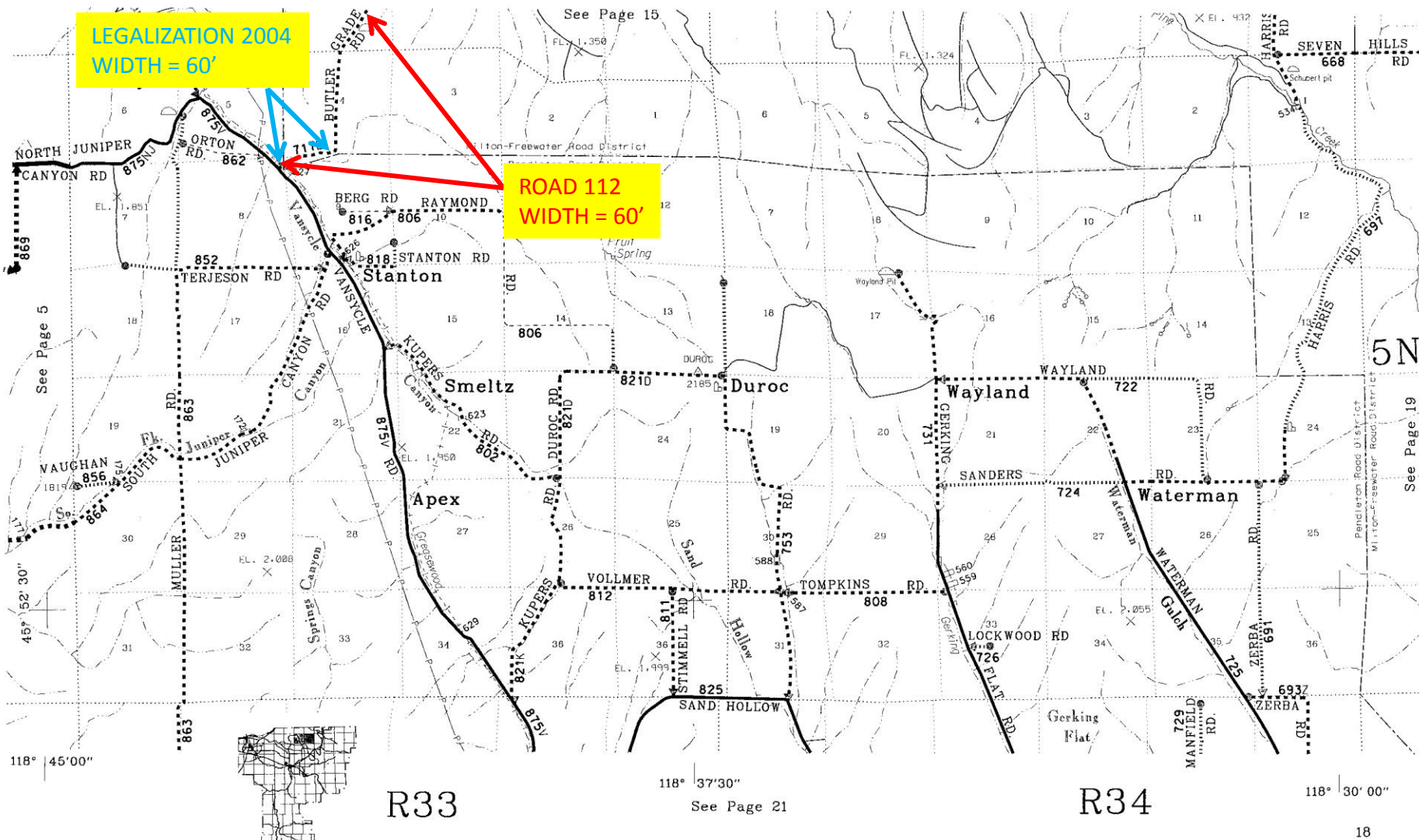

See Page 15

See Page 5

5N

See Page 19

R33

118° 37' 30" W
See Page 21

R34

118° 30' 00" W