

38

A 35 E

R-34

Co. Line.

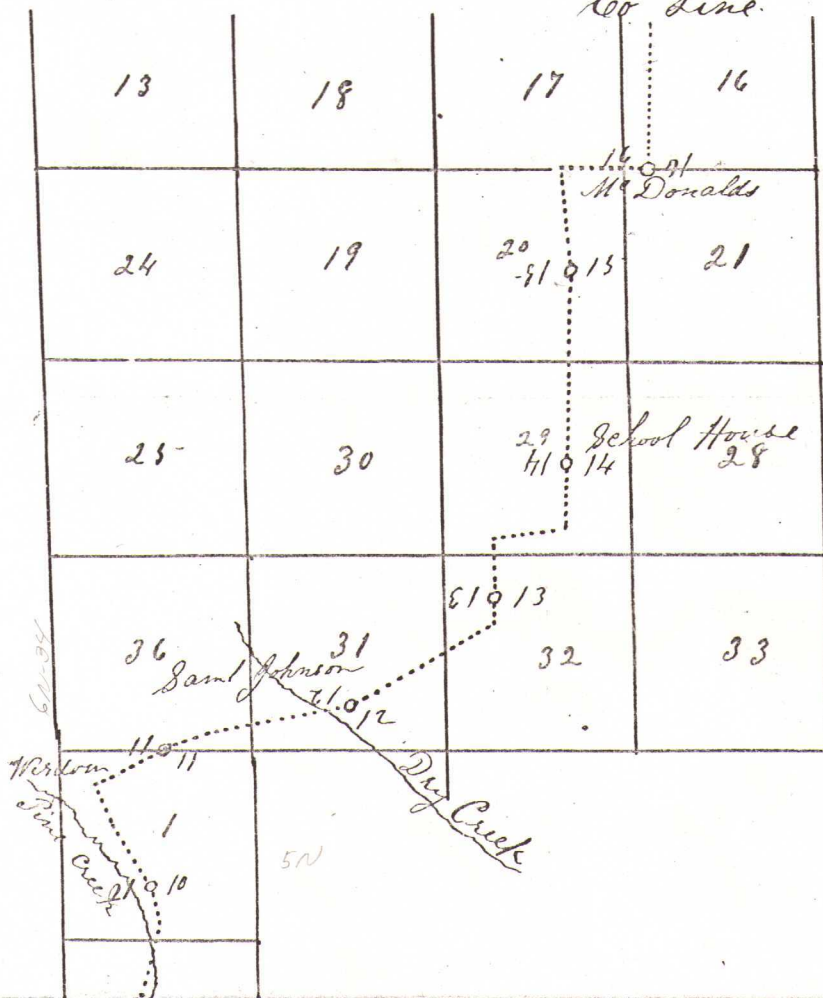

26 N

Road 35

Plat of Road 5

Filed April 4<sup>th</sup> 1874  
F. M. Conditto  
Clark

Recorded in Book "a"  
Record of Unalutka  
Community Roads and  
Field Notes page 61.

38

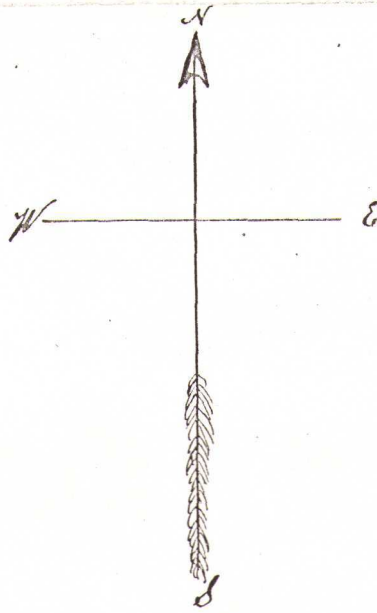
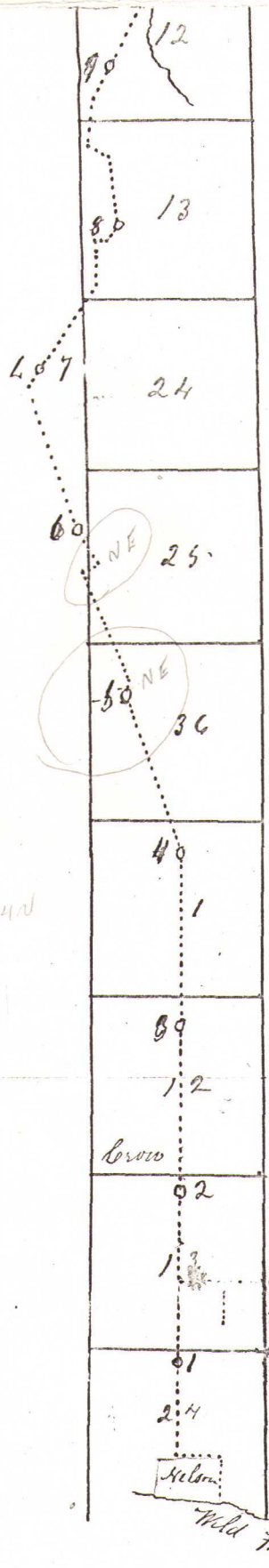

I Certify that the accompanying  
 plat is correct as taken from  
 the field notes of the survey of  
 the road from Nelson on Wild  
 Horse Creek to Co line near  
 Mc Donald

J H. Sharon  
 Co Surveyor

AFTER 5th mile, field notes call for N. westerially direction.  
 Plat shows N. Easterially directions.

2-12-79

Edw. Barber