

UMATILLA COUNTY CLERK

UMATILLA COUNTY CLERK

R 222 PAGE 742

1992 JUL -1 A 10: 37

1992 JUN 11 A 8: 26

WARRANTY DEED,
PERMANENT ACCESS EASEMENT
and
TEMPORARY CONSTRUCTION EASEMENT

173249

The City of Milton-Freewater, a municipal corporation, hereinafter referred to as Grantor, hereby conveys to Umatilla County, a political subdivision of the State of Oregon, hereinafter referred to as Grantee, the following described property:

SEE ATTACHMENT "A"

Grantor and its successors in interest hereby covenant to Grantee that Grantor is the owner in fee simple of the property described in Attachment A; that said property is free from all encumbrances save any identified herein; and that Grantor will warrant and defend the title herein conveyed from all other claims against it.

Grantor further conveys to Umatilla County a construction easement of limited duration to allow the county to reconstruct the Marie Dorian Bridge and adjacent right-of-way, across the following described property:

SEE ATTACHMENT "B"

Grantor further conveys to Grantee a permanent access easement across the property described in Attachment B for purposes of any necessary maintenance and repair to the retaining wall which Grantee will be constructing on the property described on Attachment A.

The true and actual consideration for this conveyance is one dollar (\$1.00).

THIS INSTRUMENT WILL NOT ALLOW USE OF THE PROPERTY DESCRIBED IN THIS INSTRUMENT IN VIOLATION OF APPLICABLE LAND USE LAWS AND REGULATIONS. BEFORE SIGNING OR ACCEPTING THIS INSTRUMENT, THE PERSON ACQUIRING FEE TITLE TO THE PROPERTY SHOULD CHECK WITH THE APPROPRIATE CITY OR COUNTY PLANNING DEPARTMENT TO VERIFY APPROVED USES.

DATED this 10th day of June, 1992.

GRANTOR:

James A. Swain
City of Milton-Freewater

UMATILLA COUNTY BOARD
OF COMMISSIONERS

Glenn Youngman, Chairperson

William S. Haggell, Commissioner



R 222 REC 743

Page 2 - Warranty deed, Permanent Access Easement, Temporary Construction Easement

ATTEST

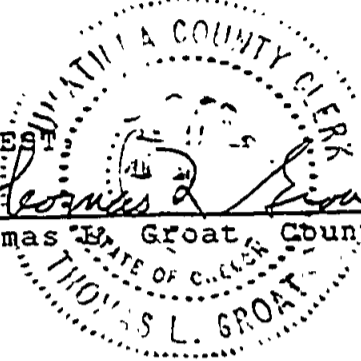

Thomas B. Groat
 Thomas B. Groat, County Clerk

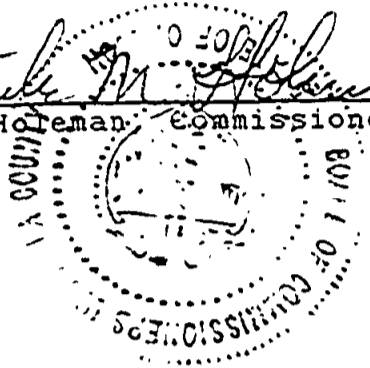

Emile M. Holeman
 Emile Holeman, Commissioner

State of Oregon)
County of Umatilla) ss.

The foregoing Warranty Deed, Permanent Access Easement, and Temporary construction Easement were acknowledged before me this 16th day of June, 1992, by James A. Swaine on behalf of the City of Milton-Freewater, Grantor.

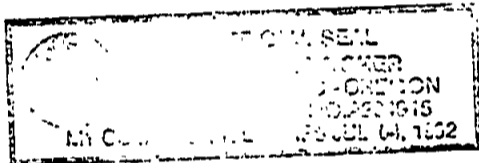

NOTARY PUBLIC
 JAMES A. SWAINE
 1002231615
 MI. CO. UMATILLA COUNTY, OREGON

James A. Swaine
 Notary Public
 My commission expires: 7-4-92

L

L

L

R 222 met 742

MARIE DORIAN BRIDGE

Apparent Owner: City of Milton-Freewater
Assessment Parcel No. 5N3618C TL 1700

Description for right-of-way, being a portion of that property described in Deed recorded in Umatilla County Deed Book 133, Page 260, located in the Southwest one-quarter of Section 18, Township 5 North, Range 36 East, Willamette Meridian, Umatilla County, Oregon, said right-of-way being the Southerly 10.00 feet of a 30.00-foot wide strip of land, the Northerly line of said 30.00-foot wide strip of land being more particularly described as follows:

Beginning at the intersection of the center of Couse Creek County Road with the center of the main channel of the Walla Walla River;

THENCE Westerly 140 feet along said center of Couse Creek County Road.

Anderson-Perry & Associates, Inc.
P.O. Box 1107
La Grande, Oregon 97850

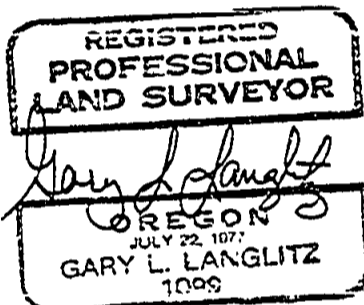

MARCH 31, 1992

Attachment "A"

MARIE DORIAN BRIDGE

Apparent Owner: City of Milton-Freewater
Assessment Parcel No. 5N3618C TL 1700

TEMPORARY CONSTRUCTION EASEMENT AND PERMANENT ACCESS EASEMENT

Description for temporary construction easement and permanent access easement, being a portion of that property described in Deed recorded in Umatilla County Deed Book 133, Page 260, located in the Southwest one-quarter of Section 18, Township 5 North, Range 36 East, Willamette Meridian, Umatilla County, Oregon, said temporary construction easement being the southerly 80.00 feet of a 100.00-foot wide strip of land, the northerly line of said 100.00-foot wide strip of land being more particularly described as follows:

Beginning at the intersection of the center of Couse Creek County Road with the center of the main channel of the Walla Walla River;

THENCE westerly 80 feet along said center of Couse Creek County Road to the TRUE POINT OF BEGINNING of said strip of land.

THENCE 80 feet along said center of Couse Creek Road.

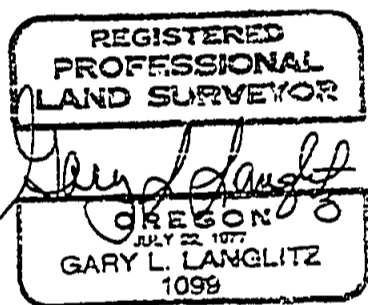

Anderson-Perry & Associates, Inc.
P.O. Box 1107
La Grande, Oregon 97850

Attachment "B"

L

L

L

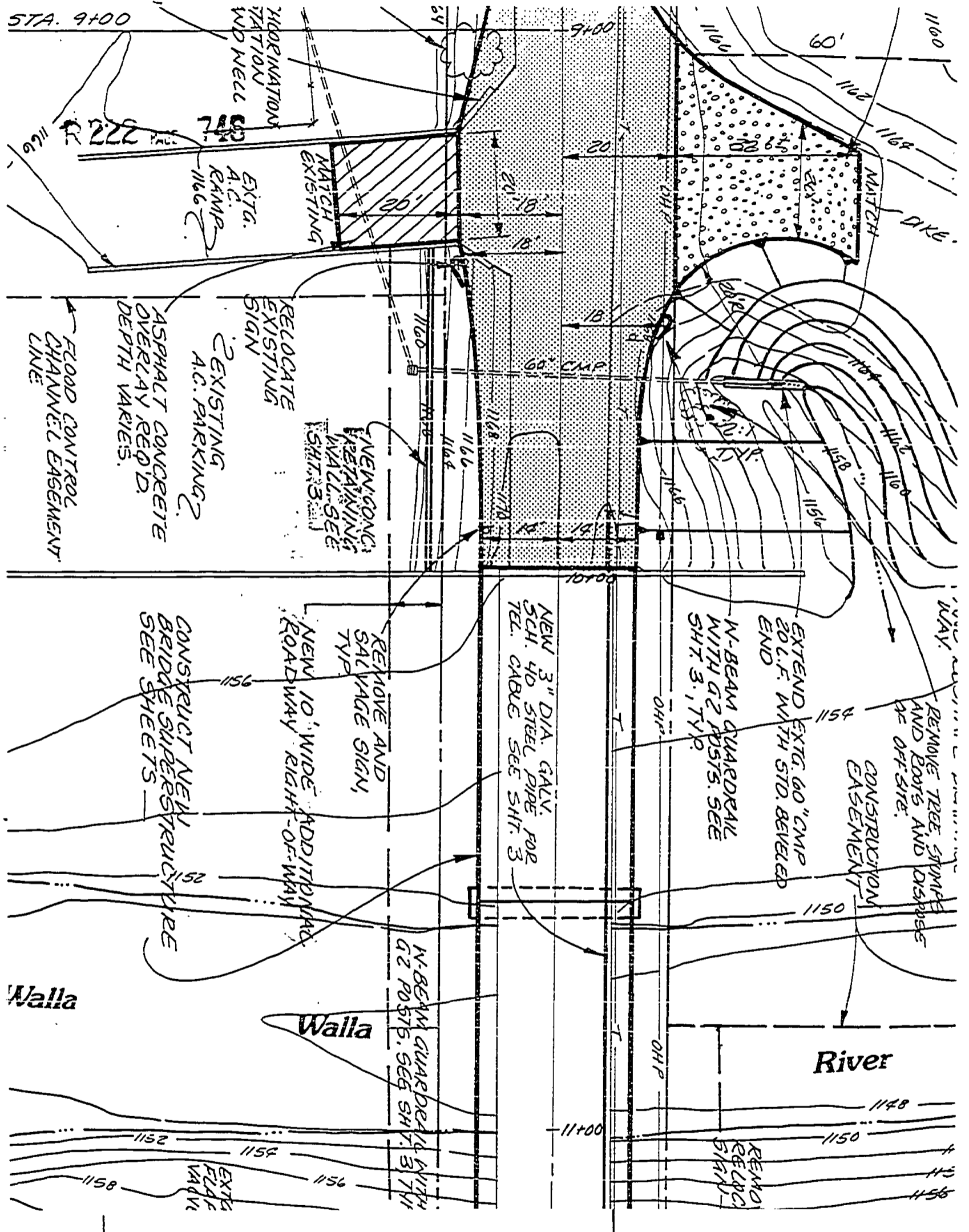

STA. 9+00

1166

ASPHALT CONCRETE
OVERLAY REQ'D.
DEPTH VARIES.

CONSTRUCT NEW
BRIDGE SUPERSTRUCTURE
SEE SHEETS

Walla

1152

1158

HYDROLOGICAL
STATION
WD WELL

EXISTG.
A.C.
RAMP

RELOCATE
EXISTING
SIGN

REMOVE AND
SALVAGE SIGN,
TYP

Walla

1156

1159

MATCH
EXISTING

NEW CONC
RETAINING
WALL. SEE
SHT. 3

NEW 10' WIDE
ADDITIONAL
ROADWAY RIGH-
OF-WAY

Walla

1160

1164

MATCH
EXISTING

N-BEAM GUARDRAIL WITH
G2 POSTS. SEE SH. 3, TYP

NEW 3" DIA. GALV.
SCH. 40 STEEL PIPE FOR
TEL. CABLE SEE SH. 3

11+00

1150

60" CMP

EXTEND EXISTG. 60" CMP
20 L.F. WITH STD. BEVELLED
END

1154

1156

N-BEAM GUARDRAIL
WITH G2 POSTS. SEE
SH. 3, TYP.

1150

1156

MATCH
EXISTING

REMOVE TREE STUMPS
AND ROOTS AND DISPOSE
OFF SITE.

1148

1150

MATCH
EXISTING

CONSTRUCTION
EASEMENT

1150

1156

River

1156

1158

1159

1160

1166

1168

1169

1170

1172

1174

1176

1178

1180

1182

1184

1186

1188

1190

1192

1194

1196

1198

1200

1202

1204

1206

1208

1210

1212

1214

1216

1218

1220

1222

1224

1226

1228

1230

1232

1234

1236

1238

1240

1242

1244

1246

1248

1250

1252

1254

1256

1258

1260

1262

1264

1266

1268

1270

1272

1274

1276

1278

1280

1282

1284

1286

1288

1290

1292

1294

1296

1298

1300

1302

1304

1306

1308

1310

1312

1314

1316

1318

1320

1322

1324

1326

1328

1330

1332

1334

1336

1338

1340

1342

1344

1346

1348

1350

1352

1354

1356

1358

1360

1362

1364

1366

1368

1370

1372

1374

1376

1378

1380

1382

1384

1386

1388

1390

1392

1394

1396

1398

1400

1402

1404

1406

1408

1410

1412

1414

1416

1418

1420

1422

1424

1426

1428

1430

1432

1434

1436

1438

1440

1442

1444

1446

1448

1450

1452

1454

1456

1458

1460

1462

1464

1466

1468

1470

1472

1474

1476

1478

1480

1482

1484

1486

1488

1490

1492

1494

1496

1498

1500

1502

1504

1506

1508

1510

1512

1514

1516

1518

1520

1522

1524

1526

1528

1530

1532

1534

1536

1538

1540

1542

1544

1546

1548

1550

1552

1554

1556

1558

1560

1562

1564

1566

1568

1570

1572

1574

1576

1578

1580

1582

1584

1586

1588

1590

1592

1594

1596

1598

1600

1602

1604

1606

1608

1610

1612

1614

1616

1618

1620

1622

1624

1626

1628

1630

1632

1634

1636

1638

16

R 222 ~~747~~ 747

STATE OF OREGON, COUNTY OF UMATILLA
I Thomas L. Groat, County Clerk, certify that this
instrument was received and recorded on 07-01-92
at 10:37 in the record of document code type DE-WD

Location R222-0742
Document number 92-173249
Fee 0.00

Thomas L. Groat
Umatilla County Clerk

received by L. McNaught Deputy

Return to:

Commissioners' Journal