

309

309

TOWNSHIP 6 N. RANGE 33 E. W. M.

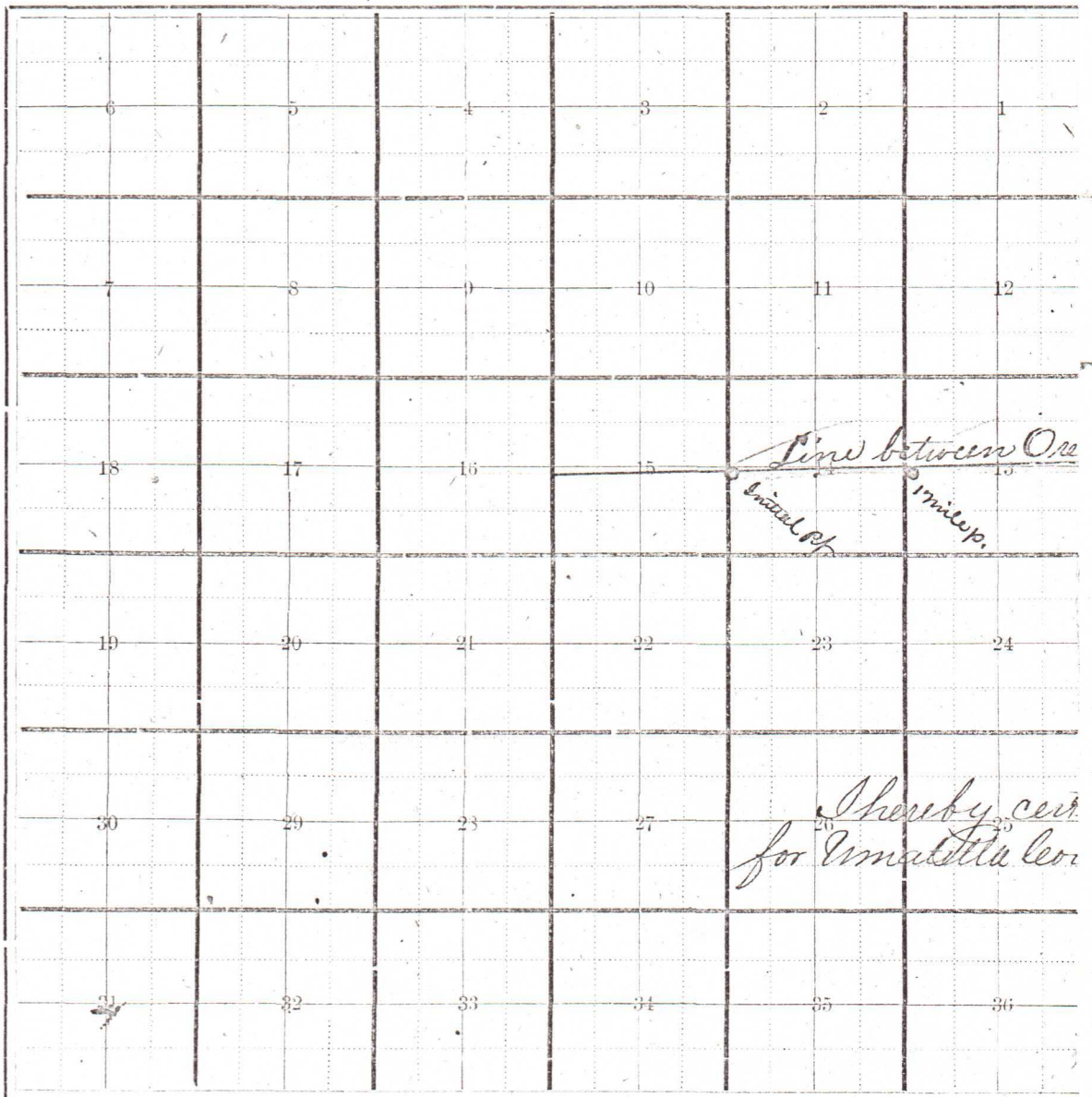

309

309

TOWNSHIP 6N RANGE 34E. W. M.

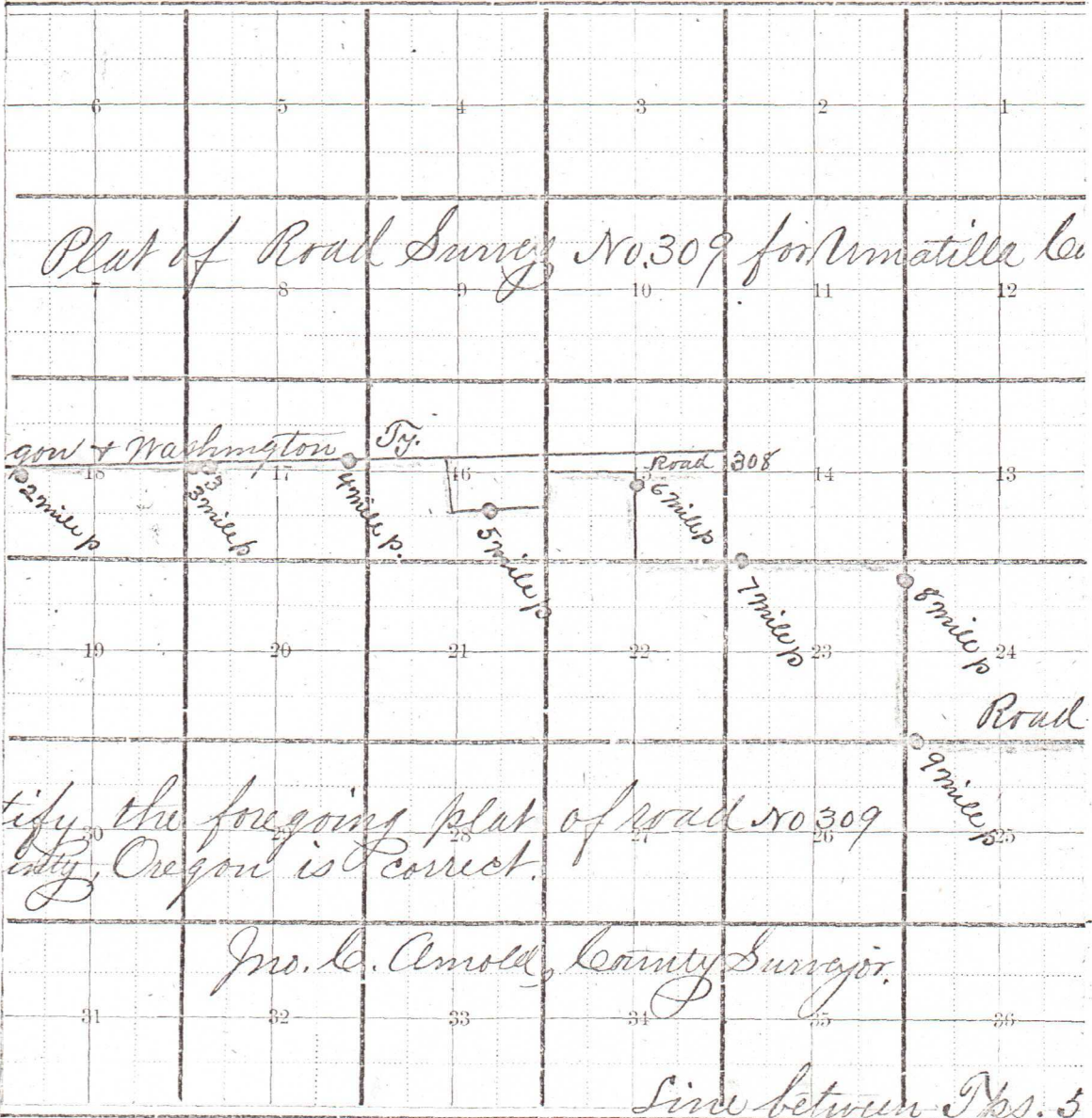

Plat of Road Survey No. 309 for Umatilla Co

2 miles p
 3 miles p
 4 miles p
 5 miles p
 6 miles p
 7 miles p
 8 miles p
 9 miles p
 Road 308
 Road
 I certify the foregoing plat of road no 309
 in the County of Oregon is correct.

Jno. L. Arnold, County Surveyor.

Line between Tps. 5

309

309

TOWNSHIP 6 N. RANGE 35 E. W. M.

