

Plat of Road No. 420

Township 3 N. Range 32 E. N. M.

I hereby certify that the following is a correct plat of Road Survey No. 420 for Unadilla Co. Or.

Jno. C. Arnold Surveyor.

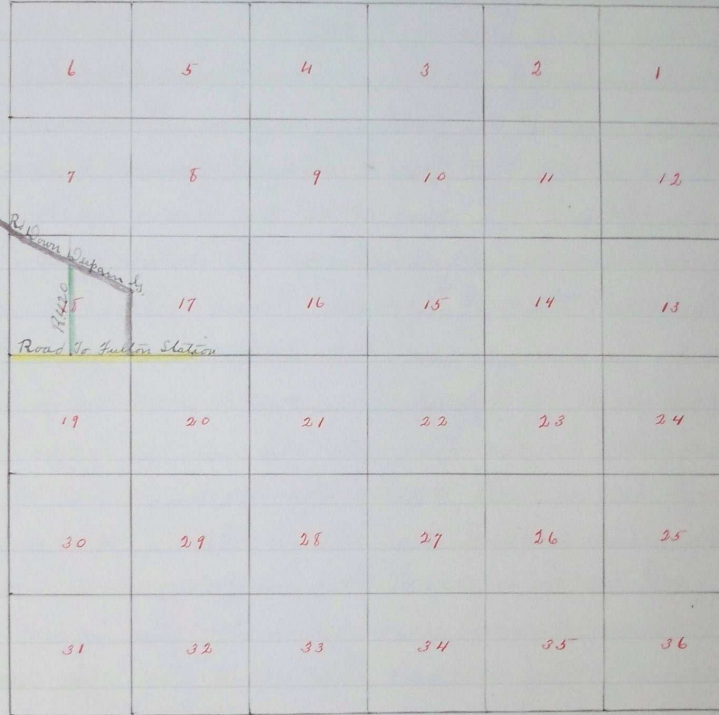

Filed May 3. 1893
 W. W. Pince
 Clerk

1474

Viewers
 sbrough
 Dalt
 ial post
 2 ft.
 18+19
 through

S.

no
 grade

es of
 ty

oyor