

Field notes of Road Survey No 378, for Umatilla County, Oregon
 Met Jno. Caplinger, W.C. Kern and Wm Scott viewers
 on Road No. 378, called J.B. Bryan and J.C. Hill to chain
 and J.C. Hill to mark. Administer oath to each.

I set initial post #5 links north of an angle post in
 a County R, about 80 rods East of center of Sec 22 T5 N R. 33 E,
 from said a.p. I run.

N 40° 25' W	9.60	Set a.p. 1 and turn R 48° 00'
N 7° 35' E	11.00	Spur of R.R. Y course E+W.
	11.83	Main R.R. Track
	12.78	Set a.p. 2 and turn L 55° 07'
N 47° 32' W	15.90	Terminus #5 links N marked R on S face in mound 2' high x 4' base.

I hereby certify that the foregoing notes of Road Survey
 No 378, for Umatilla County, Oregon are correct.

Filed Nov. 2 1891
 W.M. Pierce Clerk
 J.C. Beam Deputy

Jno. C. Arnold Co. Surveyor
 per G.E. Waggoner Dpty.

Plat of Road Survey No 378
 Township 5 North Range 35 East

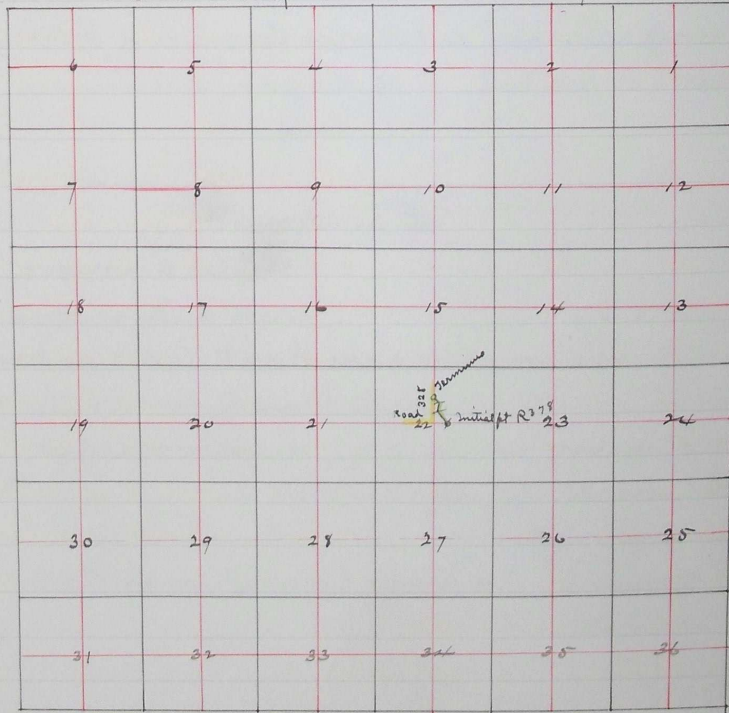

I hereby certify that the foregoing is a correct plat of Road Survey
 No 378 for Umatilla Co. Oregon.

Filed Nov. 2 1891
 W.M. Pierce Clerk
 J.C. Beam Deputy

Jno. C. Arnold
 County Surveyor.

ROAD No
 379.