

by law.
 Initial post at NW cor Sec 30 Tp 6 NR. 35 E. 10m.
 then run 81 rods South and set angle post then
 East three fourth of a mile and setting angle post run
 South one fourth of a mile, set angle post and run
 East one fourth of a mile and setting angle post
 run South one fourth of a mile. set angle
 post and run East five thousand two hundred
 and seventy seven 5277 feet to intersection
 of Hudson Bay road.

Filed July 26 1891
 W. M. Pierce Clerk

J. W. Lawray
 Surveyor

ROAD NO
 354

I hereby certify the following to be a correct plat of the No 352 Road
 survey Tp 6. NR. 35 E. 10m. as made by me Jan 26 1891

J. W. Lawray Surveyor

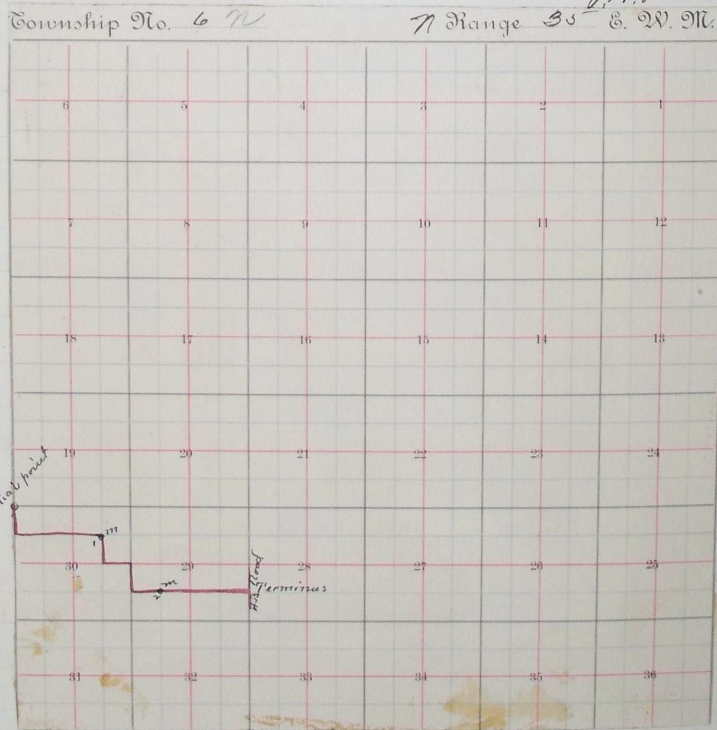

Filed July 26 1891
 W. M. Pierce Clerk

Jan 9 1891 H 653-710