

.75 Cross Juniper - course W b. N - Arcend gently 6'
4.62 Corner for Sections 2, 3, 10 & 11 T. 5 N. R. 32 E.

Set Terminus 30 lks N. of true point.

All the stakes & posts used are of legal dimensions, & marks, & are set in legal mounds - The road will be, comparatively, easily opened & is much needed as a public highway

March 25th 1887

I hereby certify the foregoing to be a true copy of the field notes of the survey of County Road 280

Jno. C. Arnold,
Co. Surveyor.

Filed March 28th 1887 }
G. A. Hartman Clerk }
92

ROAD No
323.

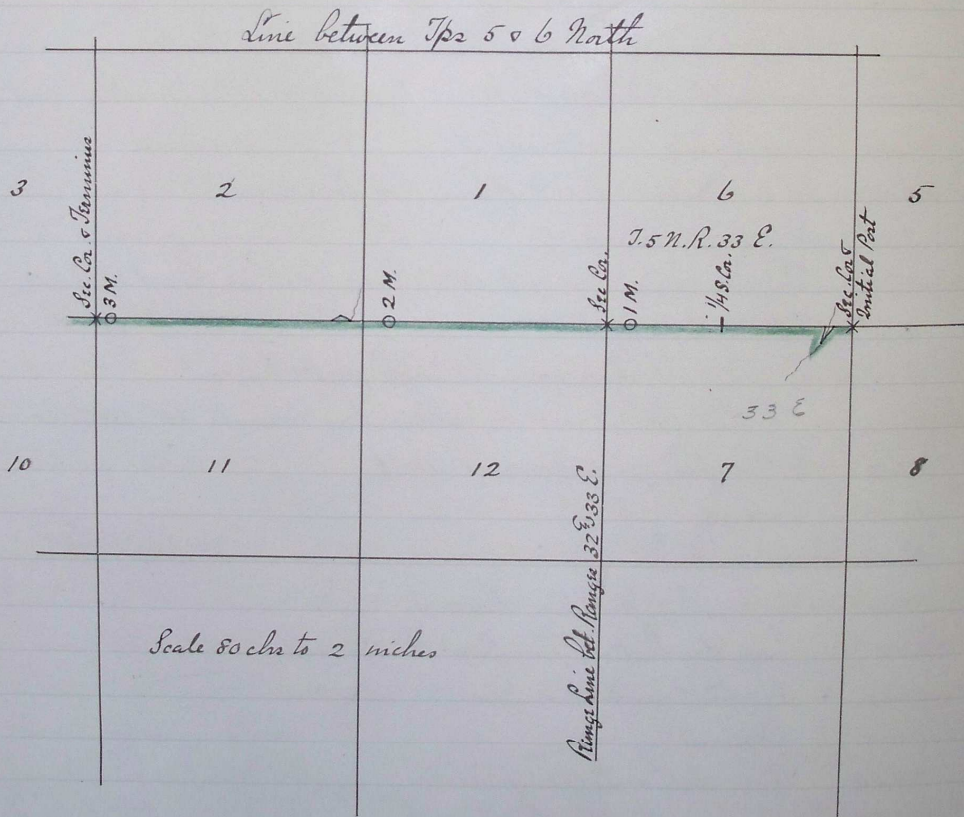

I hereby certify the foregoing to be a correct plat of
Road 280 for Umatilla County, Oregon

Jno. C. Arnold
County Surveyor

Filed March 28th 1887 }
G. A. Hartman, Clerk. }
93

North
2.5
15.00
30.00
32.00
40.82
61.50
64.75
68.50
80.00
2.28