

HORIZONTAL CONTROL DATA

OREGON STATE PLANE, NORTH ZONE (3601)

STA. NAME: 9325

QUARTER SECTION: SW

GEODETIC COOR: NAD 83(91)

SEC. 15 TWP.4 N,RGE.28E
UMATILLA CO.ORE.

LAT: 45°49'27.20057" N

DATE SET: JULY ,1993

LONG: 119°18'35.64629" W

SURVEYOR: WALTER L. CASWELL
PLS 737

SP. COOR: NAD 83(91)

N: 788840.627 INT.FT.

FIRM: EAGLE GPS SURVEY CORP
13545 NW SCIENCE PARK DR
PORTLAND, OR. 97229
(503) 643-1073

E: 8505490.116 INT.FT.

THETA: 0°50'38.403"

TYPE: GPS

SCALE FACTOR: 0.999960060

ORDER: SECOND, CLASS: 1

ELEV: 517.089 US.FT.

ELEV. DATUM: NGVD 29

DIRECTIONS "TO REACH"

FROM THE INTERSECTION OF 207 AND GETTMAN ROAD, TRAVEL EAST 450'
ON GETTMAN ROAD TO MONUMENT ON SOUTH RIGHT OF WAY. (GETTMAN ROAD
IS SOUTH OF HIGHLAND AVE. 0.8 MILE).

STATION IS A 5/8" X 30" IRON ROD WITH A YELLOW PLASTIC CAP
INSCRIBED "BUFORD ASSOC. PLS 1148".

STATION IS 10 FEET SOUTH OF CENTERLINE, 12 FEET NORTH OF 6 FOOT
BARB WIRE FENCE.

METERS X 3.28083333333 = U.S. FEET
METERS X 3.28083989501 = INTERNATIONAL FT.

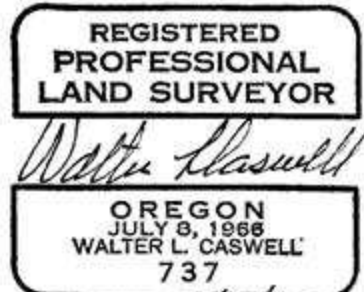

EXP. 12/31/93