

A RECORD OF SURVEY OF LANDS OWNED BY SHIRLEY HARRIS, LOCATED IN THE NORTHEAST 1/4 OF THE NORTHWEST 1/4 OF SEC. 12, T.5N, R.35E, W.M., BEING A PART OF THE CITY OF MILTON FREEWATER, OREGON.

BASIS OF BEARINGS
I HAVE HELD COORDINATE VALUES FOR MONUMENTS AT THE INTERSECTION OF 7TH AND MILL AND A R.R. SPIKE ON THE EAST END OF 7TH ST., AS GIVEN ON SURVEY 05-014-C.

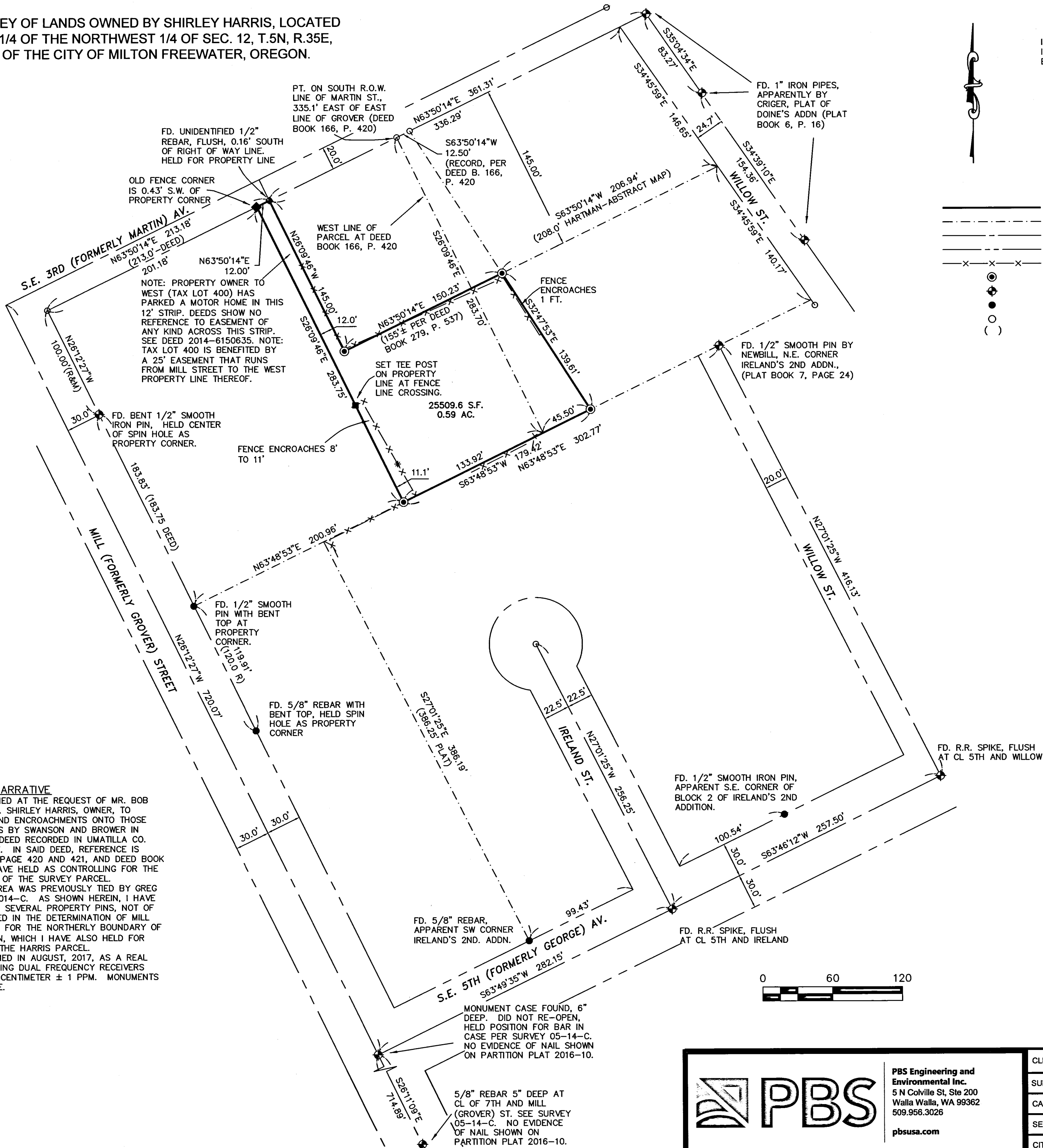

- LEGEND**
- SURVEYED PROPERTY BOUNDARY
 - - - - - DEED OR PLAT LINE
 - STREET CENTERLINE
 - RIGHT OF WAY LINE
 - x-x-x- EXISTING FENCE
 - ⊙ SET 5/8" REBAR WITH YELLOW CAP "OR2360"
 - ⊕ FOUND SURVEY MONUMENT AS DESCRIBED
 - FOUND PROPERTY PIN BY OTHERS
 - CALCULATED POINT, NOT SET
 - () RECORD DIMENSION

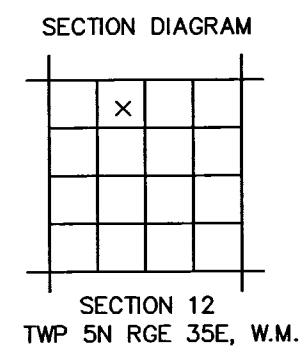

NARRATIVE

THIS SURVEY WAS PERFORMED AT THE REQUEST OF MR. BOB BAKER, SON IN LAW TO MS. SHIRLEY HARRIS, OWNER, TO LOCATE PROPERTY LINES AND ENCROACHMENTS ONTO THOSE LANDS SOLD TO MS. HARRIS BY SWANSON AND BROWER IN 1964, PURSUANT TO THAT DEED RECORDED IN UMATILLA CO. DEED BOOK 279, PAGE 537. IN SAID DEED, REFERENCE IS MADE TO DEED BOOK 166, PAGE 420 AND 421, AND DEED BOOK 164, PAGE 433, WHICH I HAVE HELD AS CONTROLLING FOR THE EASTERLY PROPERTY LINES OF THE SURVEY PARCEL. MONUMENTATION IN THIS AREA WAS PREVIOUSLY TIED BY GREG FLOWERS PER SURVEY 05-014-C. AS SHOWN HEREIN, I HAVE SEARCHED FOR AND FOUND SEVERAL PROPERTY PINS, NOT OF RECORD, WHICH I HAVE USED IN THE DETERMINATION OF MILL STREET RIGHT OF WAY AND FOR THE NORTHERLY BOUNDARY OF IRELAND'S SECOND ADDITION, WHICH I HAVE ALSO HELD FOR THE SOUTH BOUNDARY OF THE HARRIS PARCEL. THIS SURVEY WAS PERFORMED IN AUGUST, 2017, AS A REAL TIME KINEMATIC SURVEY USING DUAL FREQUENCY RECEIVERS WITH A PRECISION OF ONE CENTIMETER ± 1 PPM. MONUMENTS WERE VISITED AT THAT TIME.

RECEIVED BY
Umatilla County Surveyor
Date: 9/18/17
Rec'd By: CT
No.: 17-110-R

REGISTERED
PROFESSIONAL
LAND SURVEYOR

Paul W.P. Tomkins

OREGON
JULY 26, 1988
PAUL W.P. TOMKINS
2360

Sept. 12, 2017

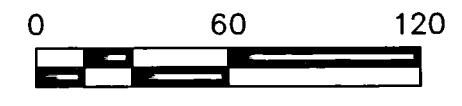

PBS Engineering and Environmental Inc.
5 N Colville St, Ste 200
Walla Walla, WA 99362
509.956.3026
pbsusa.com

CLIENT: BOB BAKER	PROJECT NO.: 67134.000
SURVEYOR: PWP TOMKINS	DATE: 08/30/2017
CALC BY: PWPT	DRAWN BY: PWPT
SECTION: NW4 S12	TOWNSHIP: 5N
CITY: MILTON-FREEWATER	COUNTY: UMATILLA
SCALE: 1"=60'	RANGE: 35E
SHEET <u>1</u> OF <u>1</u>	