

MAP  
 SHOWING LOCATION OF  
 RESIDENCE ON & BOUNDARIES OF

*Descriptive Tract Lying 80ft. E. of Block 9 - Original Town.*  
 IN THE  
*City of Athena*  
 STATE OF OREGON

Surveyed: *April 27-1953* Scale: *1 inch = 40 Feet.*

I hereby certify that I surveyed the herein described property and that I find the improvements situate thereon to be on the premises in question and that they do not overlay or encroach on the property lying adjacent thereto

*W E Criger*  
 ORE. REG. C. E. NO. *1497.*

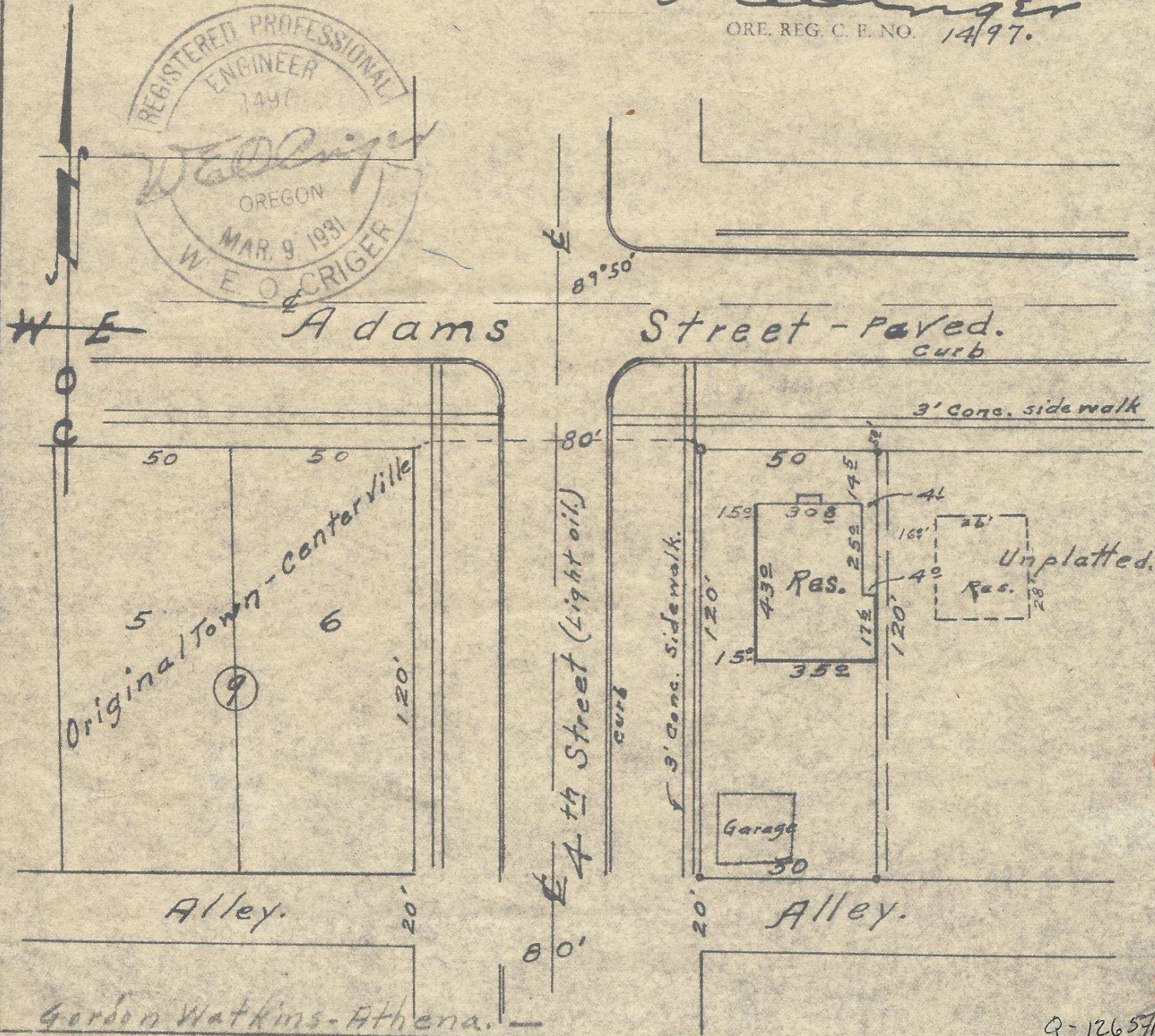

Memorandum of field notes on  
Descriptive tract in unplatted area lying  
80 ft. East of block 9 of the original town  
of Centerville (Now Athena, Ore.)

This tract is tied to the N.E. Corner of  
lot 6 of block 9 of the original town and  
is not otherwise tied to any street nor addition.  
The deed reads East and South, West  
and north on its boundaries.

I ran out three of the City Blocks and  
found that the Streets (3rd, 4th & 5th)  
bears North  $0^{\circ}10'E$ .

After locating the N.E. Corner of above  
mentioned lot 6 of block 9 I ran East 80 ft.  
to the point of beginning as noted in  
the deed. Thence I ran East 50 ft. and  
set an iron pin; thence South 120 ft. and  
set an iron pin; thence West 50 ft. where  
I set an iron pin; thence North 120 ft. where  
I set an iron pin at the exact point of  
beginning; which point lies  $1\frac{1}{2}$  ft. East of  
the East edge of the present concrete  
sidewalk.

The present residence - (built 30 or 40 years  
ago) is on the property. However the south  
end of said residence barely clears the  
east line of the tract, while the north  
end has a clearance of one tenth of a  
foot plus the four foot offset in the  
construction of the east wall.

W E O Prigg.