

Q-975-AX

☐ TENTH ST.

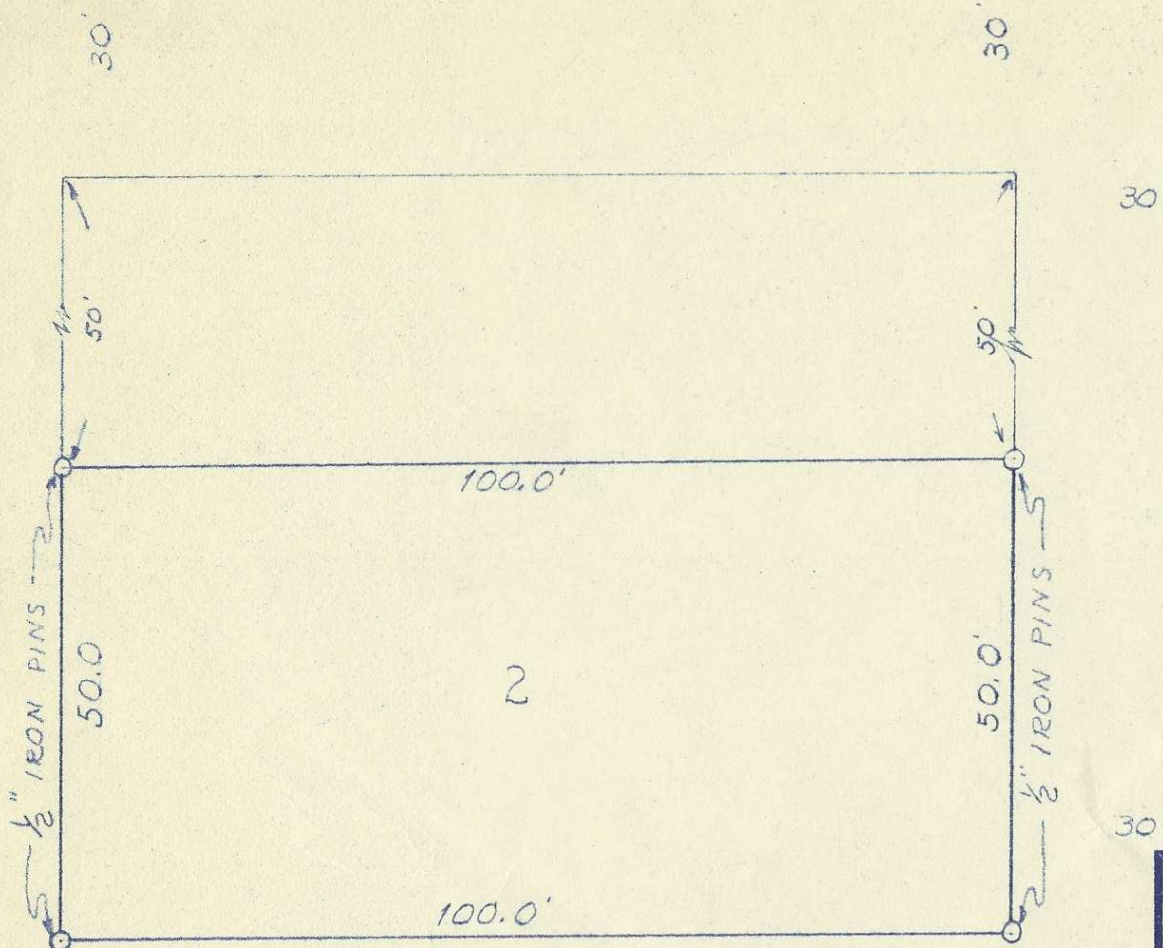

☐ PARALLEL ST.

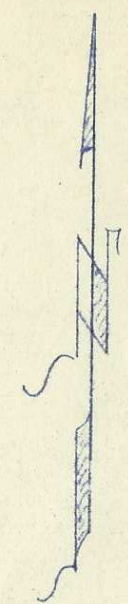

SCALE: 1" = 20' NW(1)

REGISTERED  
**OREGON**  
 LAND SURVEYOR

*G. M. Newbill*

MAY 6, 1949  
**G. M. NEWBILL**  
 255

**G. M. NEWBILL**

LICENSED LAND SURVEYOR

17 N. Second

Walla Walla, Wash.

Phone 4170

Surveys

Descriptions

Sub Divisions

SURVEY FOR

CLARENCE GRANT

LOT 2, BLOCK 30

ORIGINAL TOWN OF FREEWATER

Date 4 APRIL 1956

Drawn By DR DENT

Checked By

No. 1774

99