

REGISTERED
PROFESSIONAL
LAND SURVEYOR
David H. Krumbein
OREGON
JULY 22, 1970
DAVID H. KRUMBEIN
933

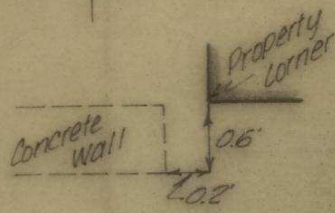

DETAIL
NTS.

M-3

KRUMBEIN ENGINEERING CO. ENGINEERS - SURVEYORS - PLANNERS 216 S.E. 1st, Pendleton, Oregon	SCALE 1" = 30'
	DATE Oct. 12, 1976
Survey for Doug Louiff lot 2, block 4, "Stangier Hill Addition" Pendleton, Oregon	DRN. BY P.L.P.
	CKD. BY D.H.K.
	DRNG. NO. 76-914

M-3-A x