

Existing Paved Road

N. 89° 50' 49" W

532.60'

North line Sec. 4

NE CORNER
Sec 4, T4N, R28

0.0'

Find 3/4" I.P. in
Mnd. Of Stones

Septic Tank

150 Lin. Ft. Drain Field

334.8' to House Corner

35.4'

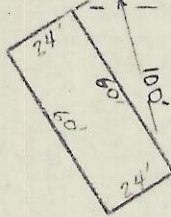

Well

302.7'

86.1'

296.0'

127.0'

100'

5.34

06.18

E

R/W Fence

ON R & N RR

by 1987

(Calc.)

4.6 Acres

NORTH 752.08'

East Line Sec. 4

E RR Track

Set 1/2" I.P.

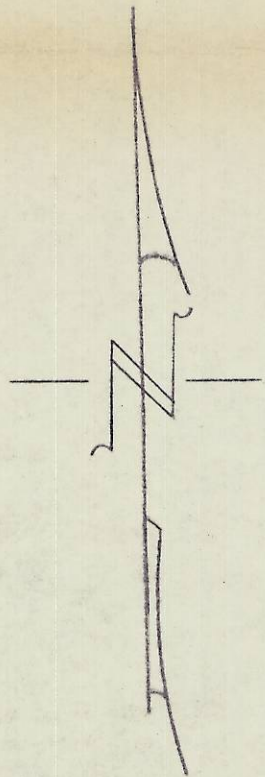

REGISTERED
PROFESSIONAL
LAND SURVEYOR

Ralph P. Thompson

OREGON
MAY 13, 1960
RALPH P. THOMPSON
506

I, the undersigned, do hereby certify that the survey shown herein is true and accurate and that I find the improvements do not overlay and/or encroach on the adjacent property.

Ralph P. Thompson

PLOT PLAN
FOR
ALLEN EVELAND
IN THE
NE 1/4 of NE 1/4 Sec 4, T4N R28E

SCALE: 1" = 60'	DATE: 5-5-72
RALPH THOMPSON	
REGISTERED LAND SURVEYOR	
P. O. BOX 1082 PENDLETON, ORE 97801	

06-405-A