

NARRATIVE:

The purpose of this survey is to stake the corners of that tract of land described in a land sale contract to Jesus Lopez, et ux., recorded on Reel 279, Page 1586. I surveyed the West line of this parcel in a 1978 survey for A.E.F. Manufacturing and the bearings and this survey are based on that survey.

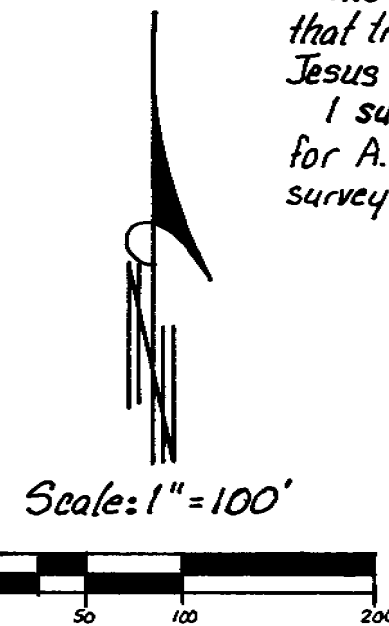

REGISTERED
PROFESSIONAL
LAND SURVEYOR

G. Dennis Edwards

OREGON
JULY 16, 1971
G. DENNIS EDWARDS
951
RENEWS 12/31/95

LEGEND:

- Found 1/2" rebar:
 - (A) Set in 1975, revised in 1977, by Me for Universal Realty.
 - (B) Set in 1976, revised in 1977, by Me for Dack.
 - (C) Set in 1978 survey by Me for A.E.F. Manufacturing.
- Set 5/8" x 30" rebar with plastic cap #951.
- (000) of Record. My 1978 Survey for A.E.F. Manufacturing.

RECEIVED BY
Umatilla County Survey Dept
L... 3-96
H... BK
Nov 96-41-A

Survey for JESUS LOPEZ
In NW 1/4 Section 34, T5N, R28E, W.M.,
Umatilla County, Oregon
11/30/95 Job #S9511188
Edwards Surveying P.O. Box 763
541-567-3336 Hermiston, Oregon 97838

96-41-A