

48R 6

2K-2

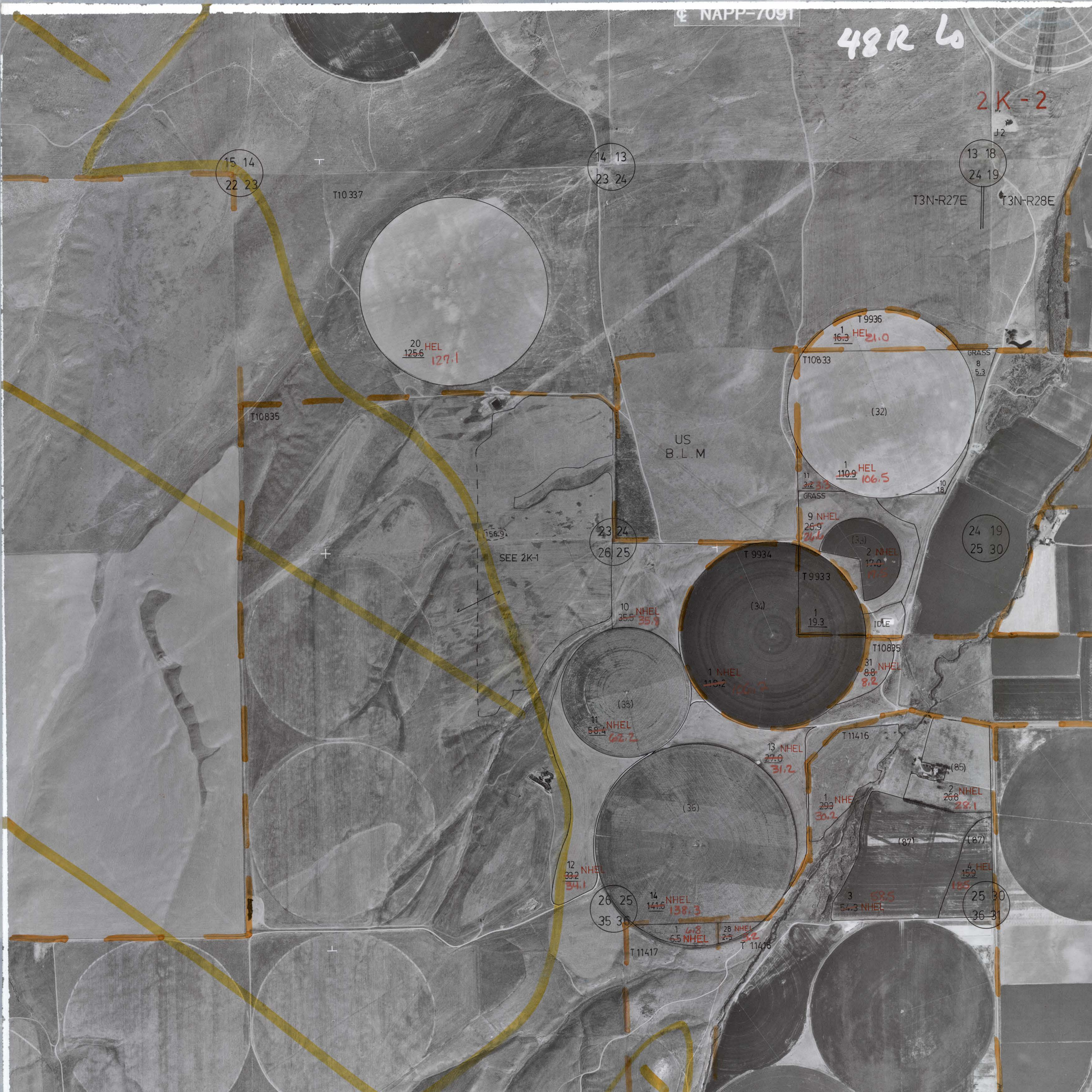

15 14
22 23

14 13
23 24

13 18
24 19

T10337

T3N-R27E

T3N-R28E

20 HEL
125.6
127.1

T9936
1 HEL
16.3 21.0
T10833
(32)
11 3.2 3.3
GRASS
1 HEL
110.9 106.5
10 1.8

T10835

US
B.L.M.

GRASS
8
5.3

23 24
26 25

24 19
25 30

156.9

SEE 2K-1

10 NHEL
35.5 35.7

T9934
(34)
T9933
1 NHEL
118.2 100.2
1 19.3
IDLE

9 NHEL
26.9 26.6
(33)
2 NHEL
17.0 17.5

T10835
31 NHEL
9.8 8.2

(35)
11 NHEL
58.4 62.2

13 NHEL
27.0 31.2

T11416

1 NHEL
29.3 30.2

(85)
2 NHEL
26.8 28.1

12 NHEL
33.2 34.1

26 25
35 36
14 NHEL
141.6 138.3

(87)
3 NHEL
54.3 68.5

(87)
4 NHEL
15.9 16.5
25 30
36 31

T11417

T11416

1 6.8
6.5 NHEL
28 NHEL
2.5 2.2