

F24  
H  
3M61

104  
7

41059-178

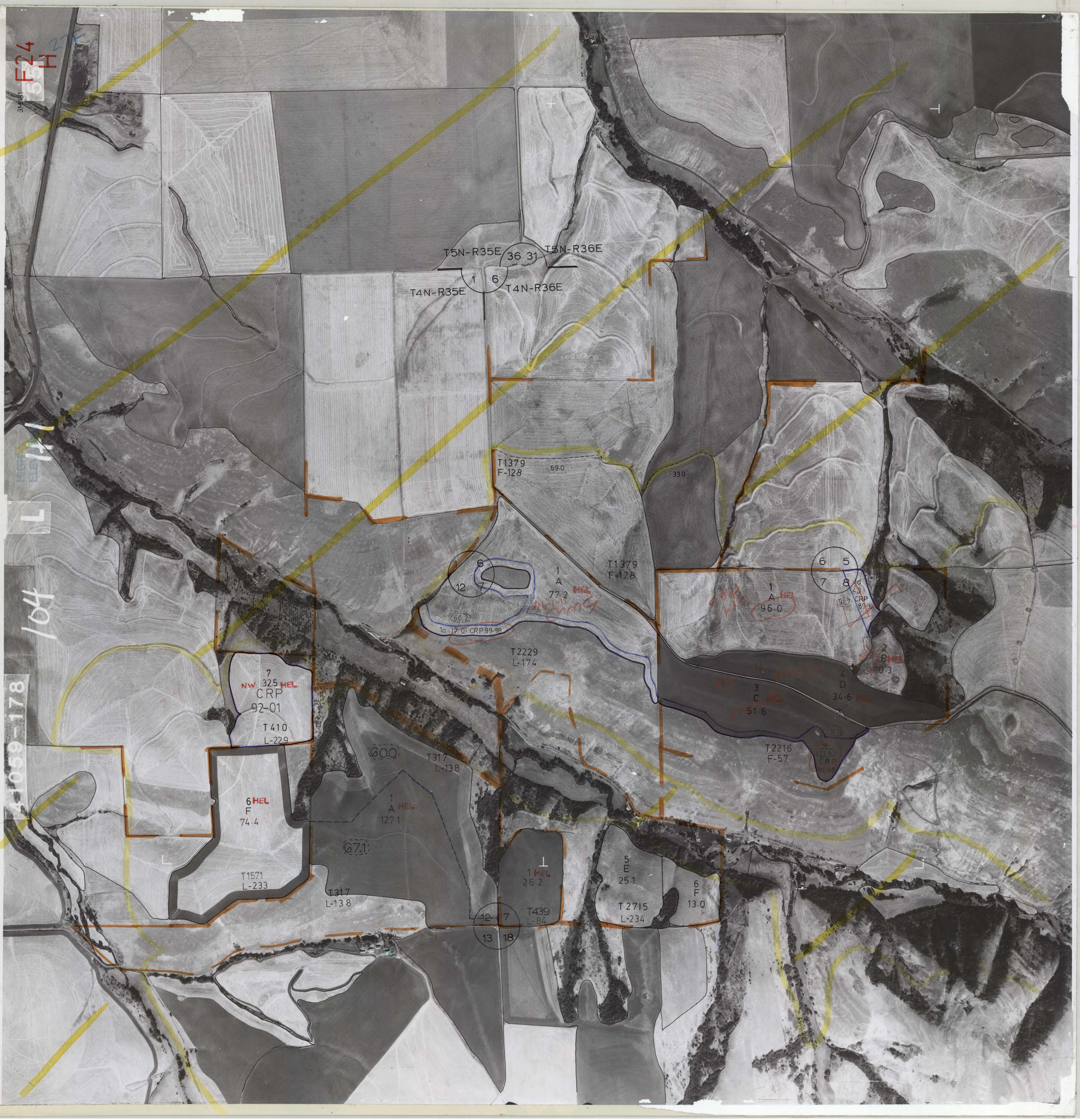

T5N-R35E 36 31  
T5N-R36E  
T4N-R35E 1 6  
T4N-R36E

T1379  
F-128  
69.0

33.9

12 6  
1 A  
77.2  
HEL  
1a 17.0 CRP 89-98

T1379  
F-128

1 A  
HEL  
96.0

6 5  
7 8  
10.3  
CRP 89-98

7  
NW 325 HEL  
CRP  
92-01  
T 410  
L-229

T2229  
L-174

3  
C  
HEL  
51.6

4  
D  
HEL  
34.6

T2216  
F-57

6 HEL  
F  
74.4

1 A  
HEL  
127.1

T1571  
L-233

T317  
L-138

1 HEL  
26.2

5  
E  
25.1

6  
F  
13.0

T439  
L-84

T2715  
L-234

12 7  
13 18