

TOWNSHIP 1 S., RANGE 36 E.W.M.

SCALE 2 IN. = 1 MILE.
DATED 1932

UMATILLA COUNTY OREGON

CHAS. F. METSKER CIVIL ENGINEER,
215 COMMERCE BLDG., PORTLAND, ORE.
930 1/2 PACIFIC AVE., TACOMA, WASH.

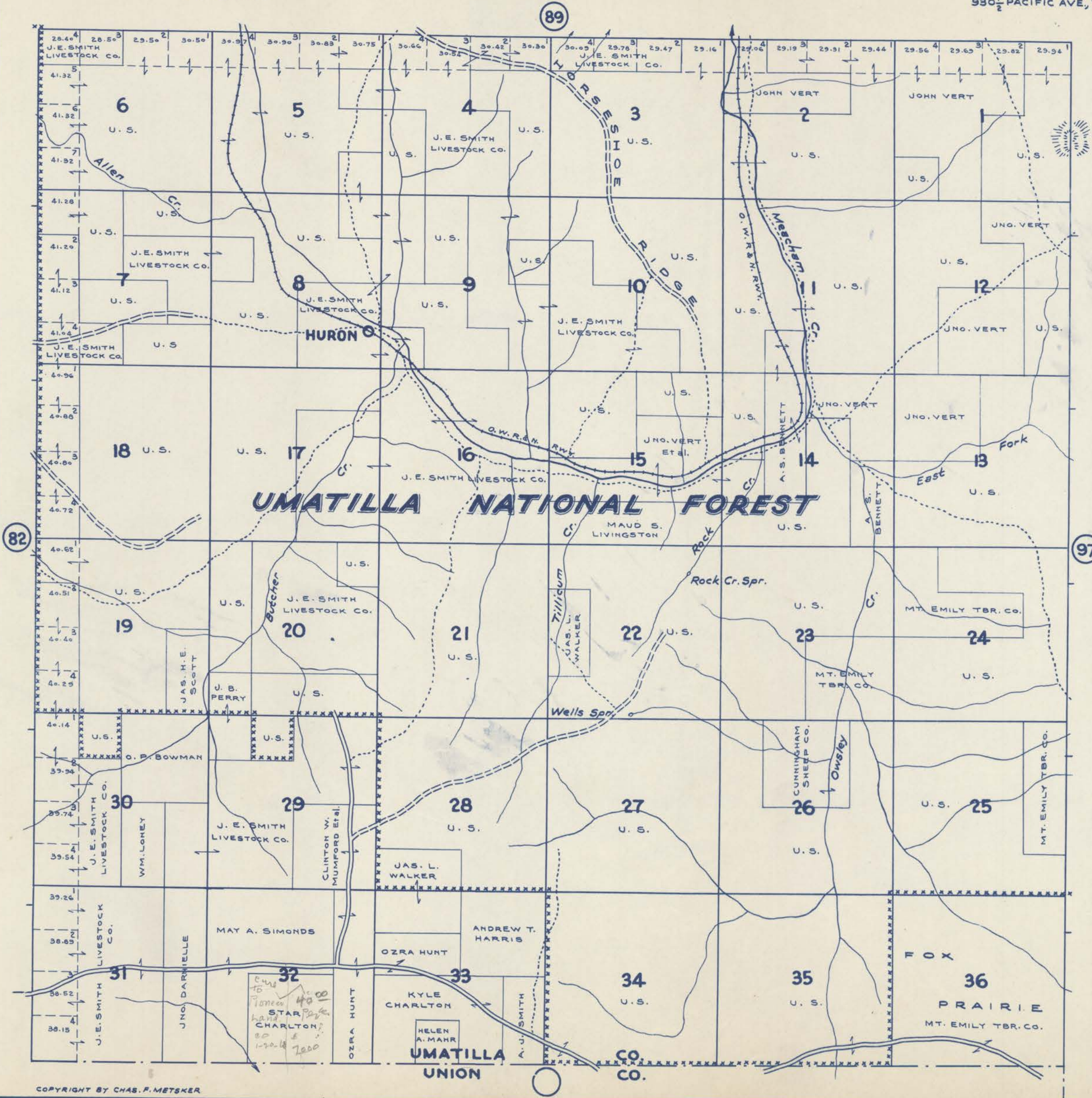

- LEGEND -

- PAVED ROADS
- STATE HIGHWAYS
- MARKET ROADS
- DIRT ROADS
- INFERIOR ROADS
- RAILROADS
- TRAILS
- INTERMITTENT CREEKS
- SCHOOLS