

TOWNSHIP 2 N., RANGE 35 E.W.M.

SCALE 2 IN. = 1 MILE.
DATED 1932

UMATILLA COUNTY OREGON

CHAS. F. METSKER CIVIL ENGINEER
215 COMMERCE BLDG, PORTLAND, ORE.
930 1/2 PACIFIC AVE, TACOMA, WASH.

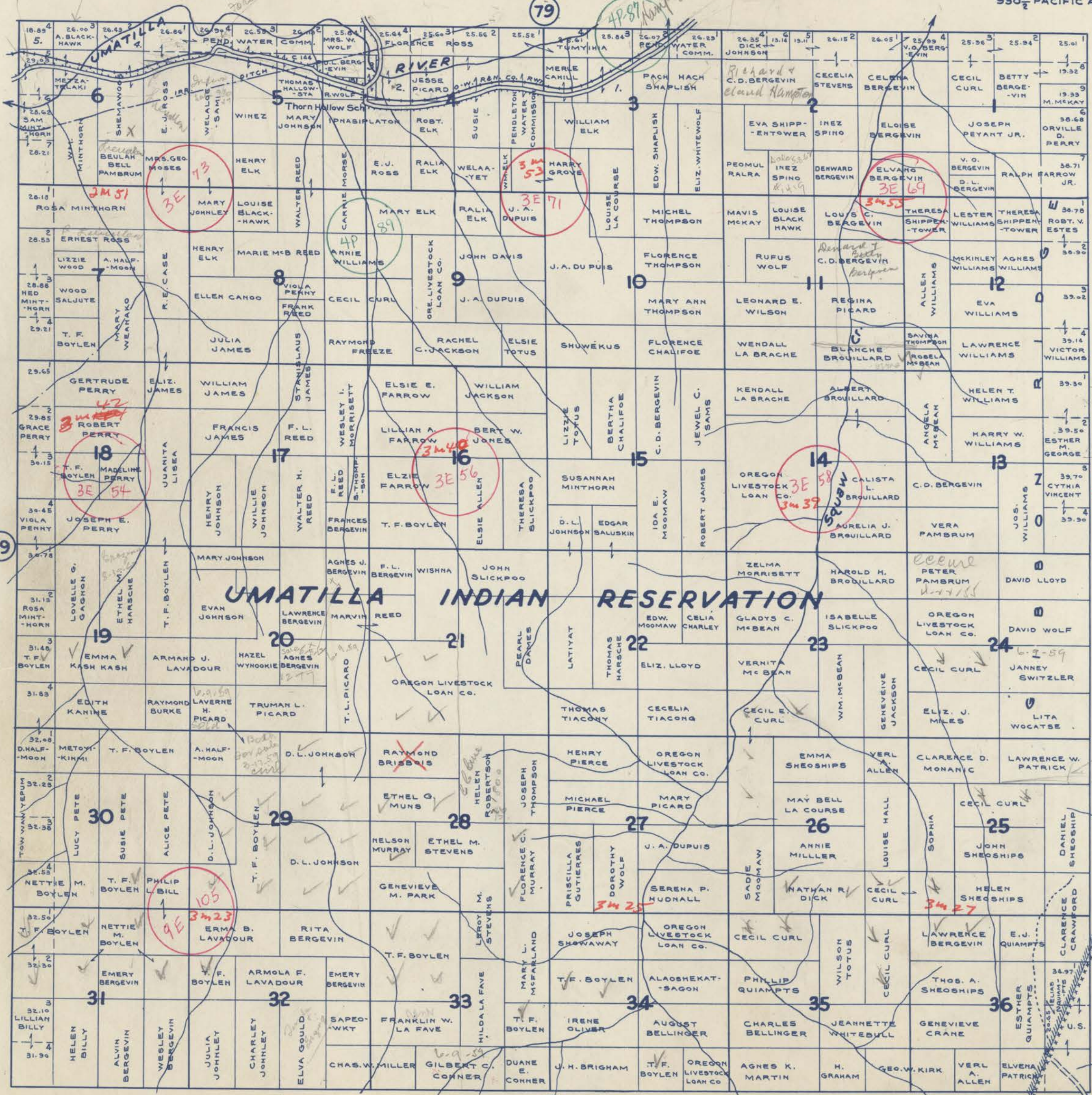

- 1-ANAMUWENOMI
- 2-GUY H. FRENCH
- 3-GEO. BRACE
- 4-ELIZA WAK WAK
- 5-NELSON SHIPPENTOWER

Handwritten note:
34 37

Handwritten note:
Patented Oct 14 - 1959
Records 11-9-59

- LEGEND -**
- PAVED ROADS
 - STATE HIGHWAYS
 - MARKET ROADS
 - DIRT ROADS
 - INFERIOR ROADS
 - RAILROADS
 - TRAILS
 - INTERMITTENT CREEKS
 - SCHOOLS