

TOWNSHIP 6 N., RANGE 35 E.W.M.

UMATILLA COUNTY OREGON

SCALE 2 IN. = 1 MILE.
DATED 1932

CHAS. F. METSKER CIVIL ENGINEER
215 COMMERCE BLDG., PORTLAND, ORE.
930 1/2 PACIFIC AVE., TACOMA, WASH.

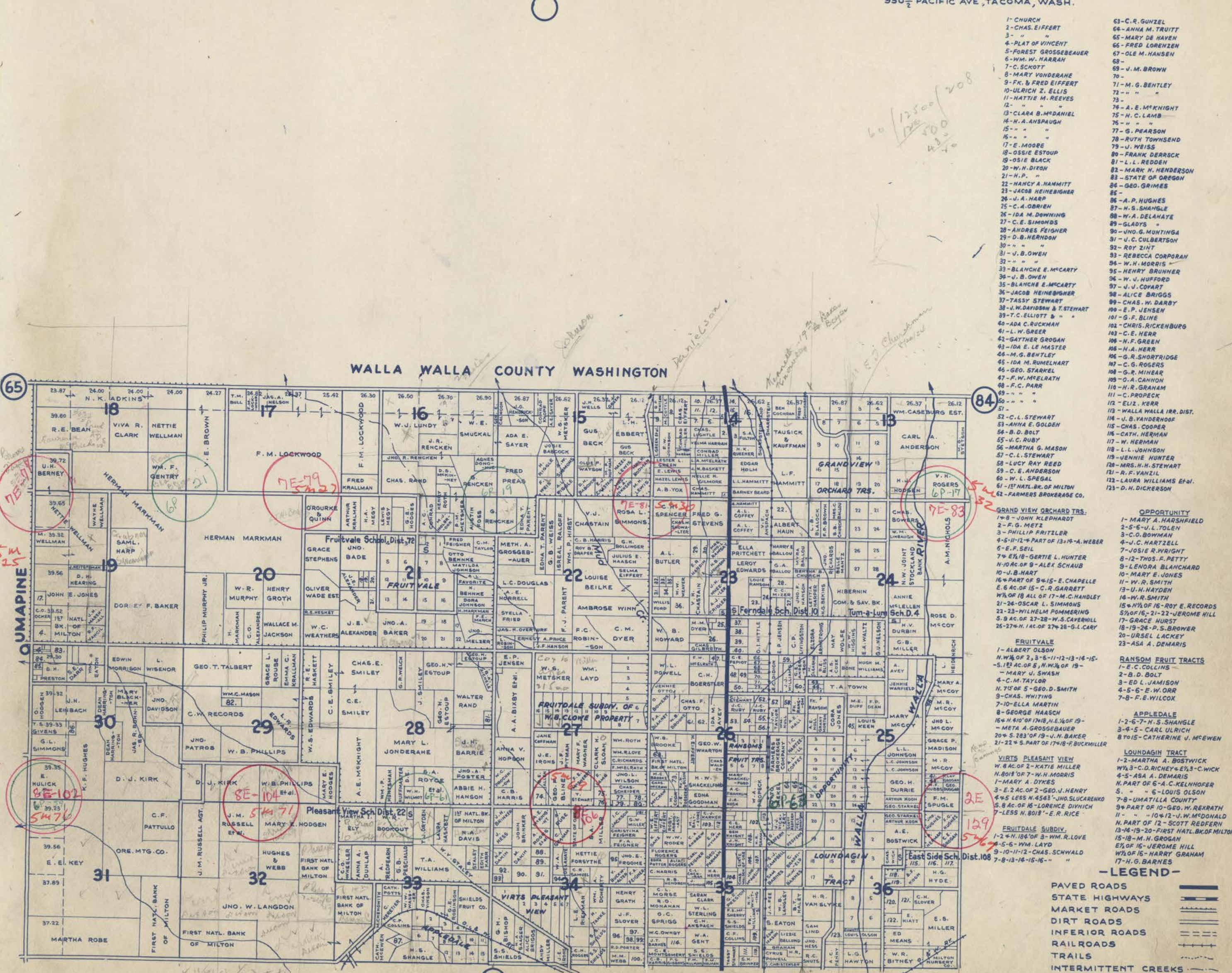

- 1-CHURCH
- 2-CHAS. EIFFERT
- 3- " "
- 4-PLAT OF VINCENT
- 5-FORREST GROSGEBAUER
- 6-WM. W. HARRAH
- 7-C. SCOTT
- 8-MARY VONDERAHE
- 9-FK. & FRED EIFFERT
- 10-ULRICH Z. ELLIS
- 11-HATTIE M. REEVES
- 12- " "
- 13-CLARA B. MCDANIEL
- 14-N. A. ANSPAUGH
- 15- " "
- 16- " "
- 17-E. MOORE
- 18-OSSIE ESTOUP
- 19-OSIE BLACK
- 20-W. H. DIXON
- 21-N. P. " "
- 22-NANCY A. HAMMITT
- 23-JACOB HEINEBIGHNER
- 24-U. A. HARP
- 25-C. A. OBRIEN
- 26-IDA M. DOWNING
- 27-C. E. SIMMONS
- 28-ANDRES FEISHER
- 29-D. B. HERNDON
- 30- " "
- 31-J. B. OWEN
- 32- " "
- 33-BLANCHE E. MCCARTY
- 34-J. B. OWEN
- 35-BLANCHE E. MCCARTY
- 36-JACOB HEINEBIGHNER
- 37-TASSY STEWART
- 38-J. W. DAVIDSON & T. STEWART
- 39-T. C. ELLIOTT & " "
- 40-ADA C. RUCKMAN
- 41-L. W. GREER
- 42-GAYTHER GROGAN
- 43-IDA E. LE MASTER
- 44-M. G. BENTLEY
- 45-IDA M. RUMELHART
- 46-GEO. STARKEL
- 47-F. W. MELRATH
- 48-F. C. PARR
- 49- " "
- 50- " "
- 51- " "
- 52-C. L. STEWART
- 53-ANNA E. GOLDEN
- 54-B. D. BOLT
- 55-U. C. RUBY
- 56-MARTHA G. MASON
- 57-C. L. STEWART
- 58-LUCY RAY REED
- 59-C. E. ANDERSON
- 60-W. L. SIEGAL
- 61-1ST NATL. BK. OF MILTON
- 62-FARMERS BROKERAGE CO.
- 63-C. R. GUNZEL
- 64-ANNA M. TRUITT
- 65-MARY DE HAVEN
- 66-FRED LORENZEN
- 67-OLE M. HANSEN
- 68- " "
- 69-J. M. BROWN
- 70- " "
- 71-M. G. BENTLEY
- 72- " "
- 73- " "
- 74-A. E. MCKNIGHT
- 75-H. C. LAMB
- 76- " "
- 77-G. PEARSON
- 78-RUTH TOWNSEND
- 79-U. WEISS
- 80-FRANK DERRSCK
- 81-L. L. REDDEN
- 82-MARK N. HENDERSON
- 83-STATE OF OREGON
- 84-GEO. GRIMES
- 85- " "
- 86-A. P. HUGHES
- 87-N. S. SHAMLE
- 88-W. A. DELAMATE
- 89-GLADYS "
- 90-UNO. G. MUNTINGA
- 91-U. C. CULBERTSON
- 92-ROY ZINT
- 93-REBECCA CORPORAN
- 94-W. H. MORRIS
- 95-HENRY BRUNNER
- 96-W. J. HUFFORD
- 97-J. J. COVART
- 98-ALICE BRIGGS
- 99-CHAS. W. DARBY
- 100-E. P. JENSEN
- 101-G. F. BLINE
- 102-CHRIS. RICKENBURG
- 103-C. E. HERR
- 104-N. F. GREEN
- 105-H. A. HERR
- 106-G. R. SHORTRIDGE
- 107-C. G. ROGERS
- 108-G. R. MINEAR
- 109-O. A. CANNON
- 110-H. R. GRAHAM
- 111-C. PROPECK
- 112-ELIZ. KERR
- 113-WALLA WALLA IRR. DIST.
- 114-U. B. VANDEBROOK
- 115-CHAS. COOPER
- 116-CATH. HERMAN
- 117-W. HERMAN
- 118-L. L. JOHNSON
- 119-JENNIE HUNTER
- 120-MRS. H. H. STEWART
- 121-R. F. VANZIL
- 122-LAURA WILLIAMS Epat.
- 123-D. H. DICKERSON

65
UMAPINE

84

8E-102
5M76

8E-104
5M71

106

2E
129
5M76

77

- LEGEND-**
- PAVED ROADS
 - STATE HIGHWAYS
 - MARKET ROADS
 - DIRT ROADS
 - INFERIOR ROADS
 - RAILROADS
 - TRAILS
 - INTERMITTENT CREEKS
 - SCHOOLS