

TOWNSHIP 2 N., RANGE 33 E.W.M. UMATILLA COUNTY OREGON

SCALE 2 IN. = 1 MILE.
DATED 1932

CHAS.F.METSKER CIVIL ENGINEER
215 COMMERCE BLDG. PORTLAND, ORE.
930 1/2 PACIFIC AVE. TACOMA, WASH.

- 1- NAME OF NATIVE TOWN
- 2- GRACE A. SIEVERS
- 3- HENRY KAUFFMAN
- 4- FARMERS NAT'L. WHESE. CORP.
- 5- BERTHA DARR
- 6- AMER. NAT'L. BANK
- 7- MELLIE FARRINGTON
- 8- FRED R. YOUNG
- 9- PETER MEURER
- 10- INLAND EMPIRE BANK
- 11- ISADORE WHITEBULL
- 12- BILL PHILLIPS
- 13- GOTTLIEB MILLER
- 14- W.A. WILSON
- 15- WM. MYRICK

SW 1/4 SW 1/4

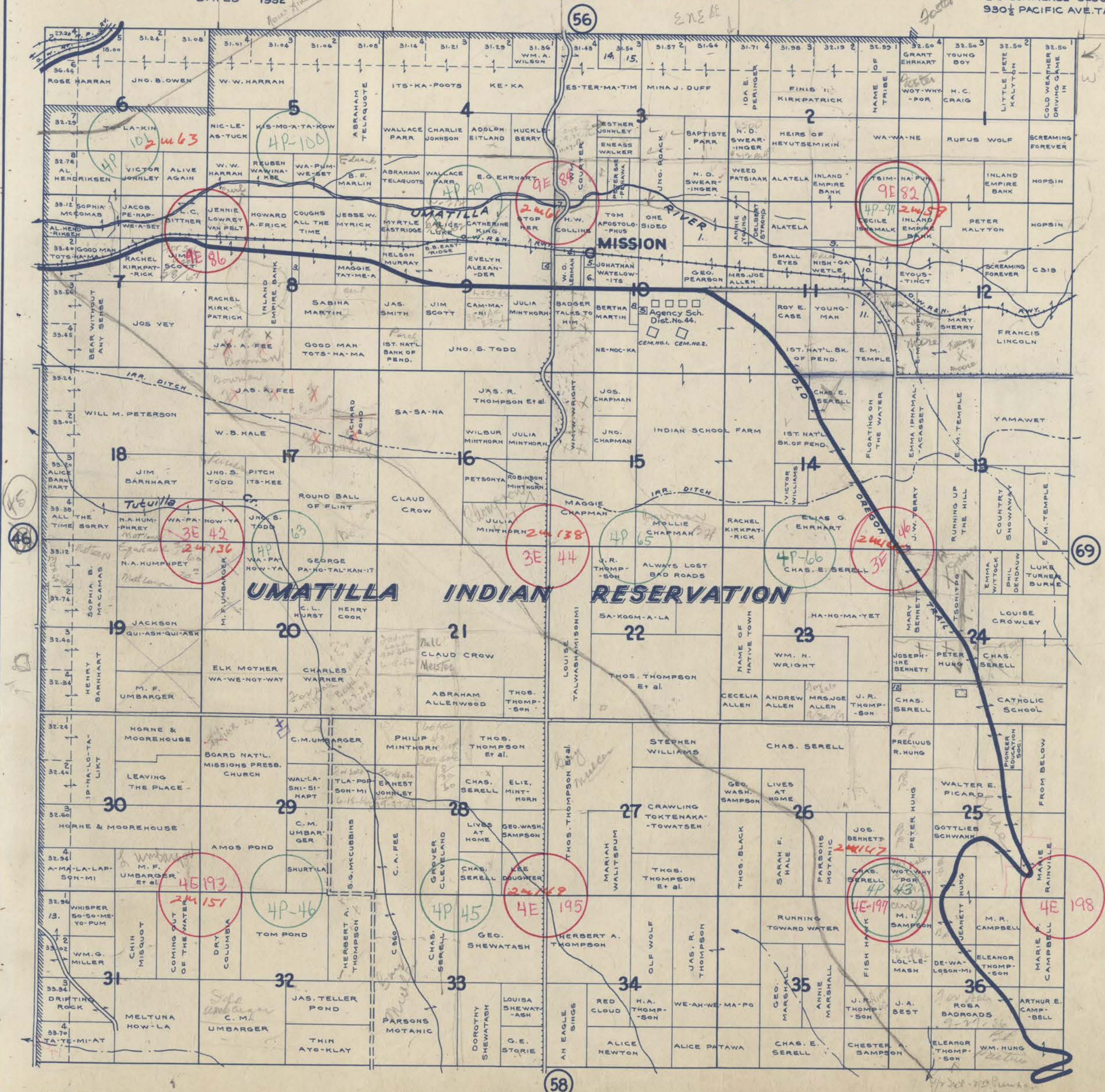

- LEGEND -
- PAVED ROADS
 - STATE HIGHWAYS
 - MARKET ROADS
 - DIRT ROADS
 - INFERIOR ROADS
 - RAILROADS
 - TRAILS
 - INTERMITTENT CREEKS
 - SCHOOLS