

# TOWNSHIP 5 N., RANGE 32 E.W.M. UMATILLA COUNTY OREGON

SCALE 2 IN. = 1 MILE.  
DATED 1932

CHAS. F. METSKER, CIVIL ENGINEER  
215 COMMERCE BLDG. PORTLAND, ORE.  
930 1/2 PACIFIC AVE. TACOMA, WASH.

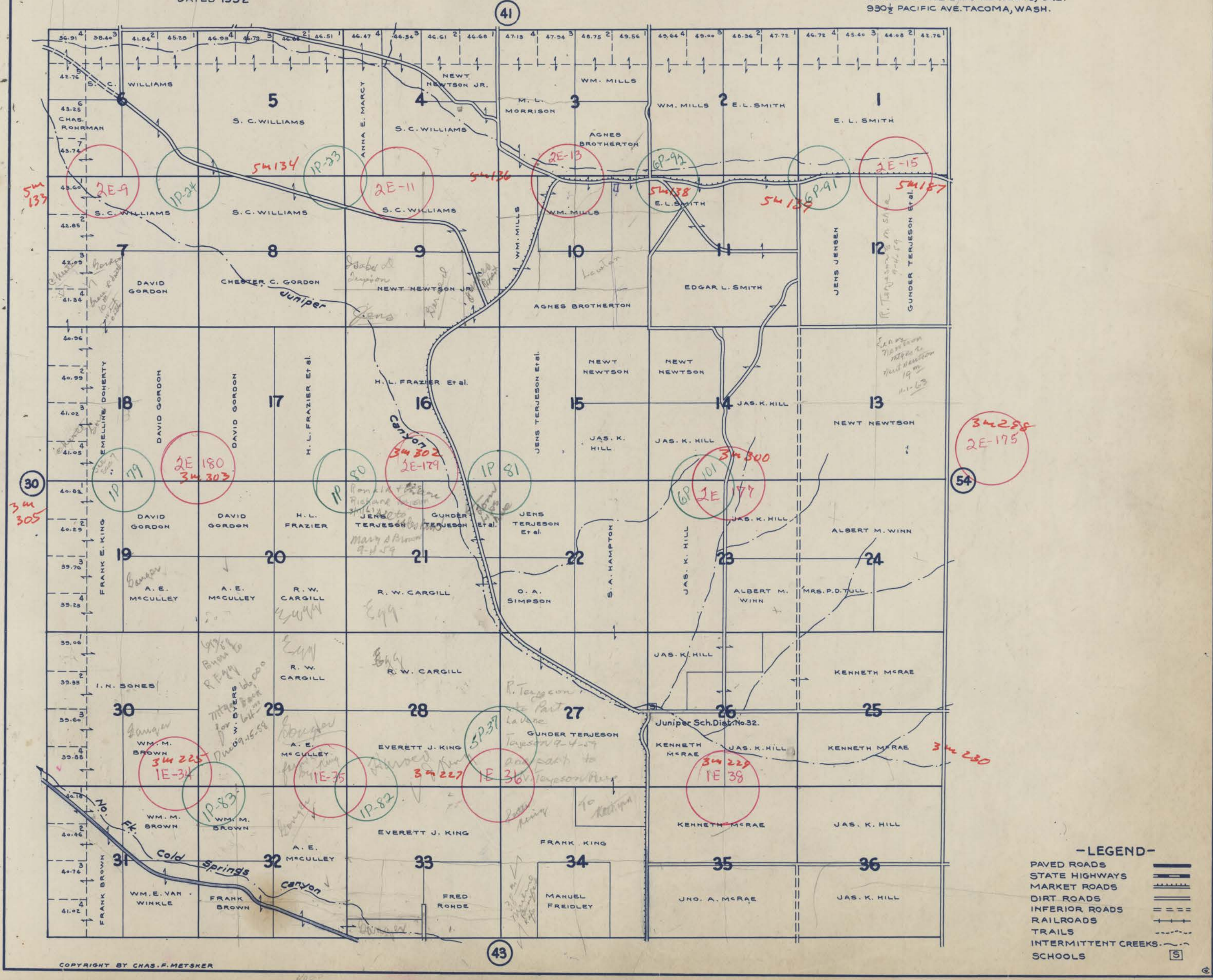

**-LEGEND-**

PAVED ROADS	—————
STATE HIGHWAYS	—————
MARKET ROADS	—————
DIRT ROADS	—————
INFERIOR ROADS	—————
RAILROADS	—————
TRAILS	—————
INTERMITTENT CREEKS	—————
SCHOOLS	—————