

TOWNSHIP 4 N., RANGE 37 E.W.M.

UMATILLA COUNTY OREGON

SCALE 2 IN. = 1 MILE.
DATED 1932

CHAS. F. METSKER CIVIL ENGINEER
215 COMMERCE BLDG., PORTLAND, ORE.
930 1/2 PACIFIC AVE., TACOMA, WASH.

- 1 - H.E. CRAWFORD
- 2 - ROY HESS
- 3 - J.E. WALDEN
- 4 - F. FERGUSON
- 5 - ROY HYATT
- 6 - C.A. WINN
- 7 - C.M. CHRISTENSEN
- 8 - W.H. COLEMAN

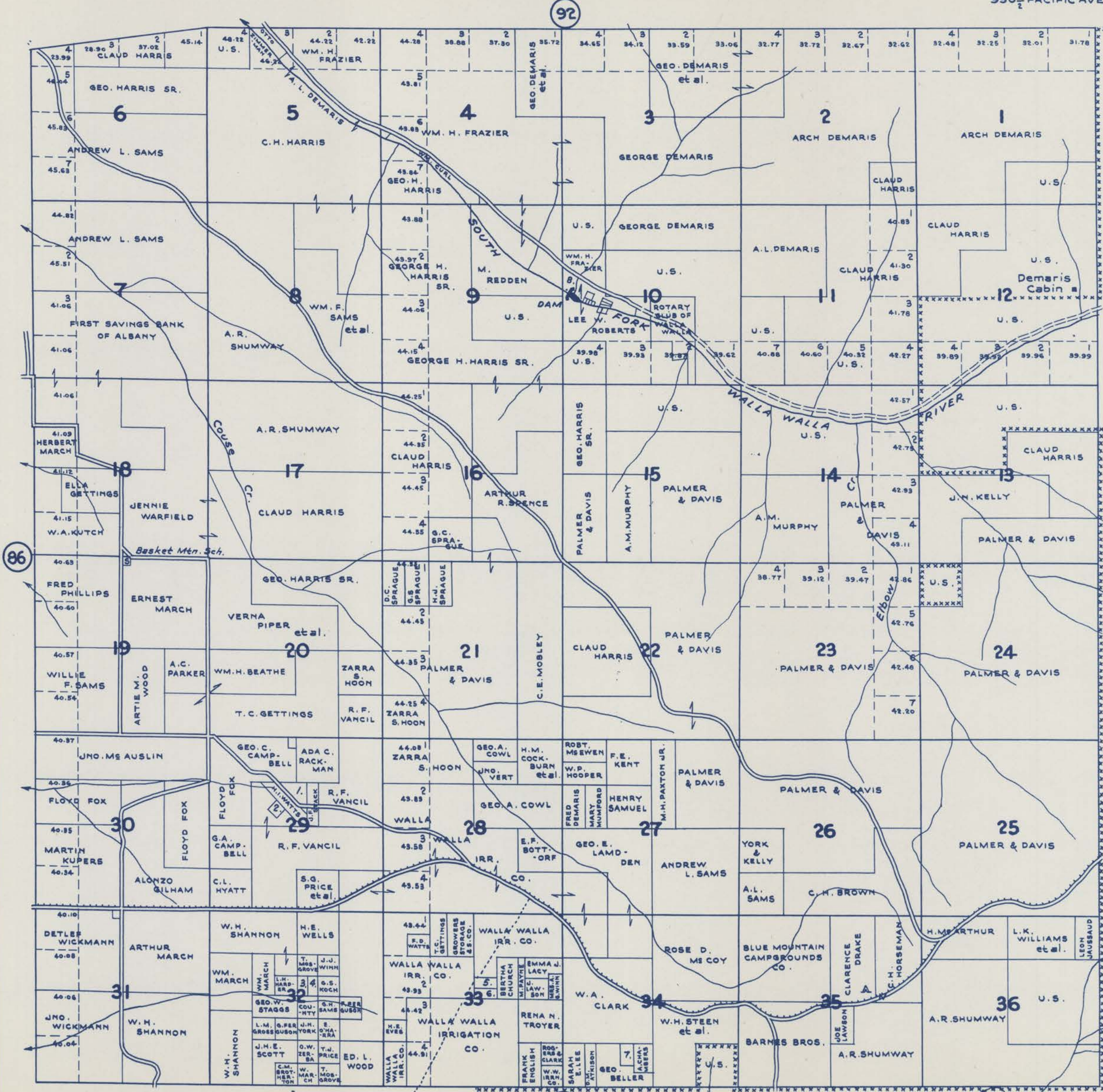

86

92

94

100

- LEGEND -**
- PAVED ROADS
 - STATE HIGHWAYS
 - MARKET ROADS
 - DIRT ROADS
 - INFERIOR ROADS
 - RAILROADS
 - TRAILS
 - INTERMITTENT CREEKS
 - SCHOOLS